

JACKSON TOWNSHIP

T 33 N, R 3W

C23

SECTION 1

SECTION 1

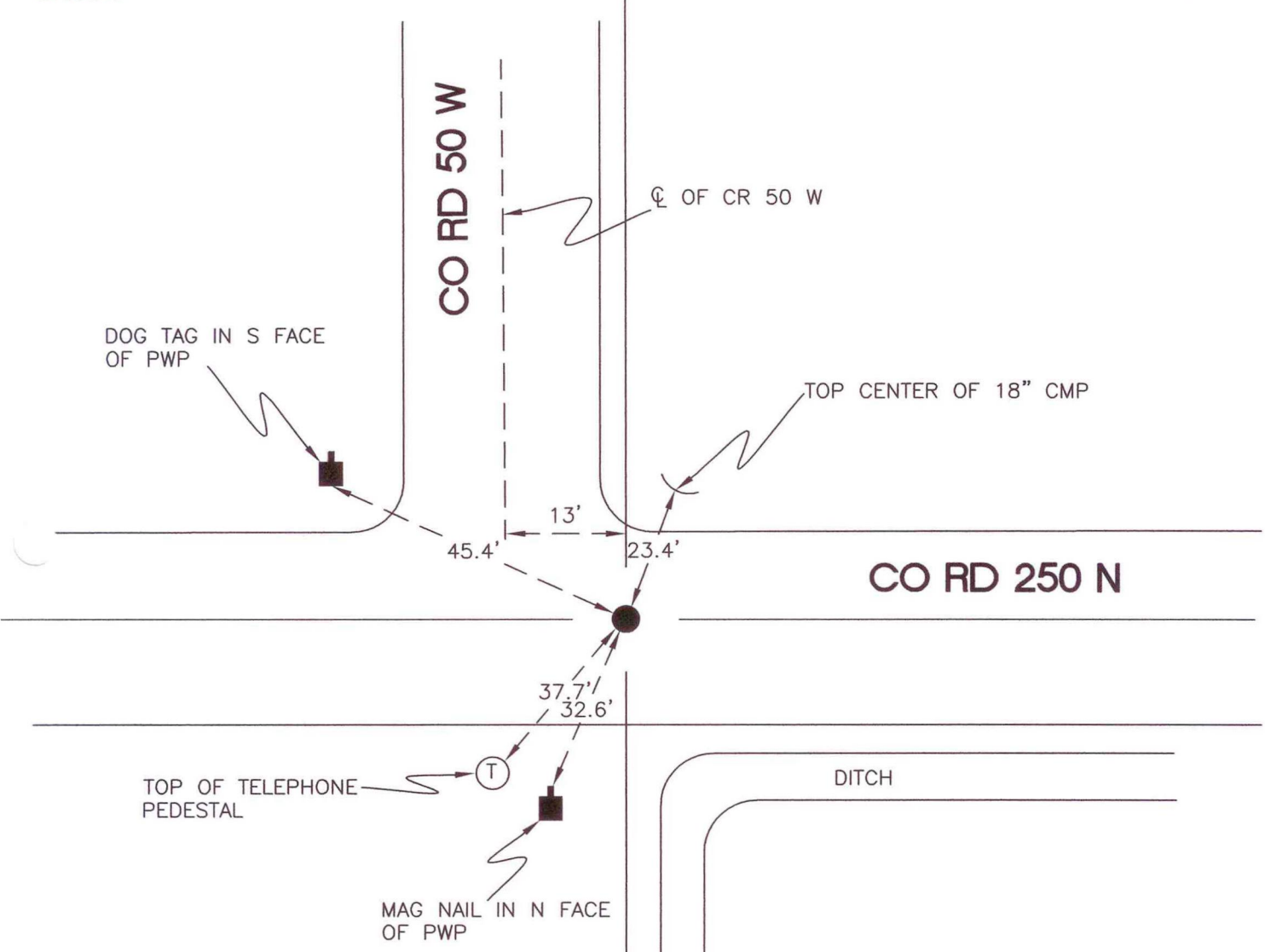

SECTION 1

SECTION 1

MONUMENT: 5/8" IRON ROD NEXT TO WOOD POST

CORNER OF: RECORD USE

PARTY: JL/PM

DATE: 5-9-2007

COMMENTS: AT GRADE; 13' E OF C/L OF 50W;
1' N OF C/L OF 250N

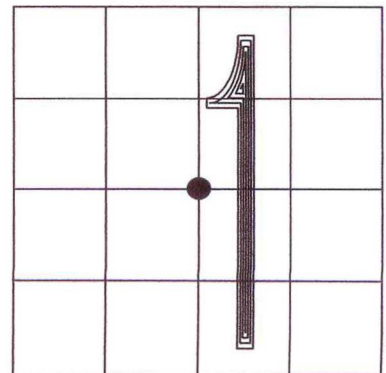

C23

CORNER LOCATION IN THE SECTION