

WAYNE TOWNSHIP

T 32 N, R 3 W

C25

SECTION 1
WAYNE TOWNSHIP

SECTION 6
CALIFORNIA TOWNSHIP

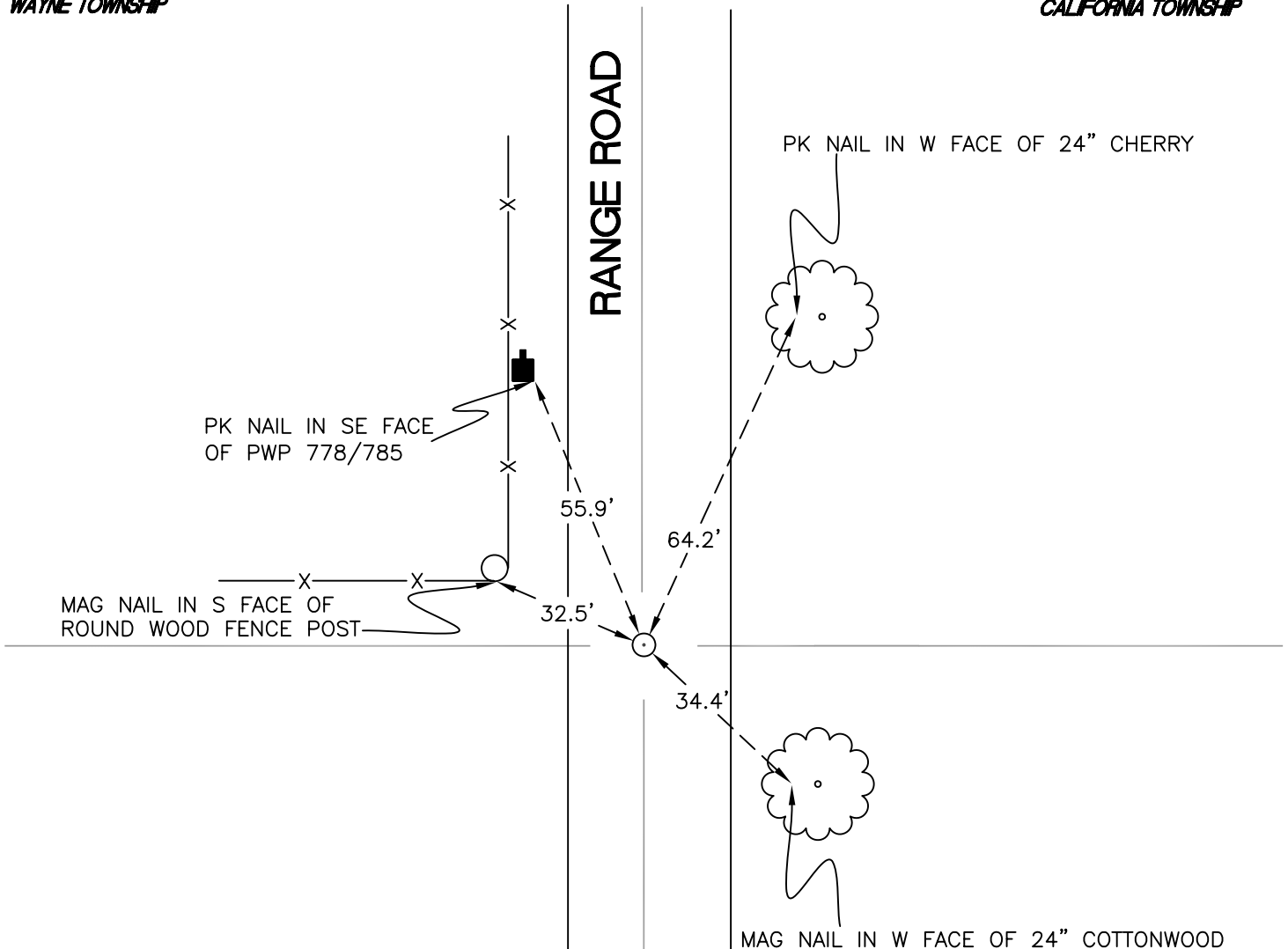

SECTION 1
WAYNE TOWNSHIP

SECTION 6
CALIFORNIA TOWNSHIP

MONUMENT: RAIL BOLT

PARTY: JL/AO

DATE: 7/11/12

COMMENTS: 3" BELOW GRADE; 1' W OF C OF
RANGE ROAD.
FOUND BY SJF IN 1986.

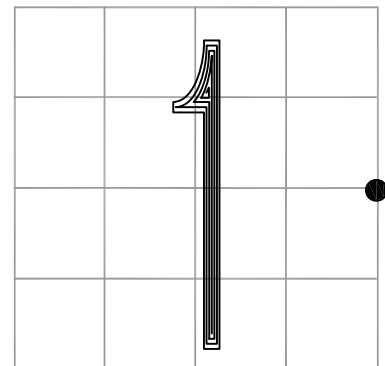

CORNER LOCATION IN THE SECTION

C25