

CENTER TOWNSHIP
T 33 N, R 2 W
E14

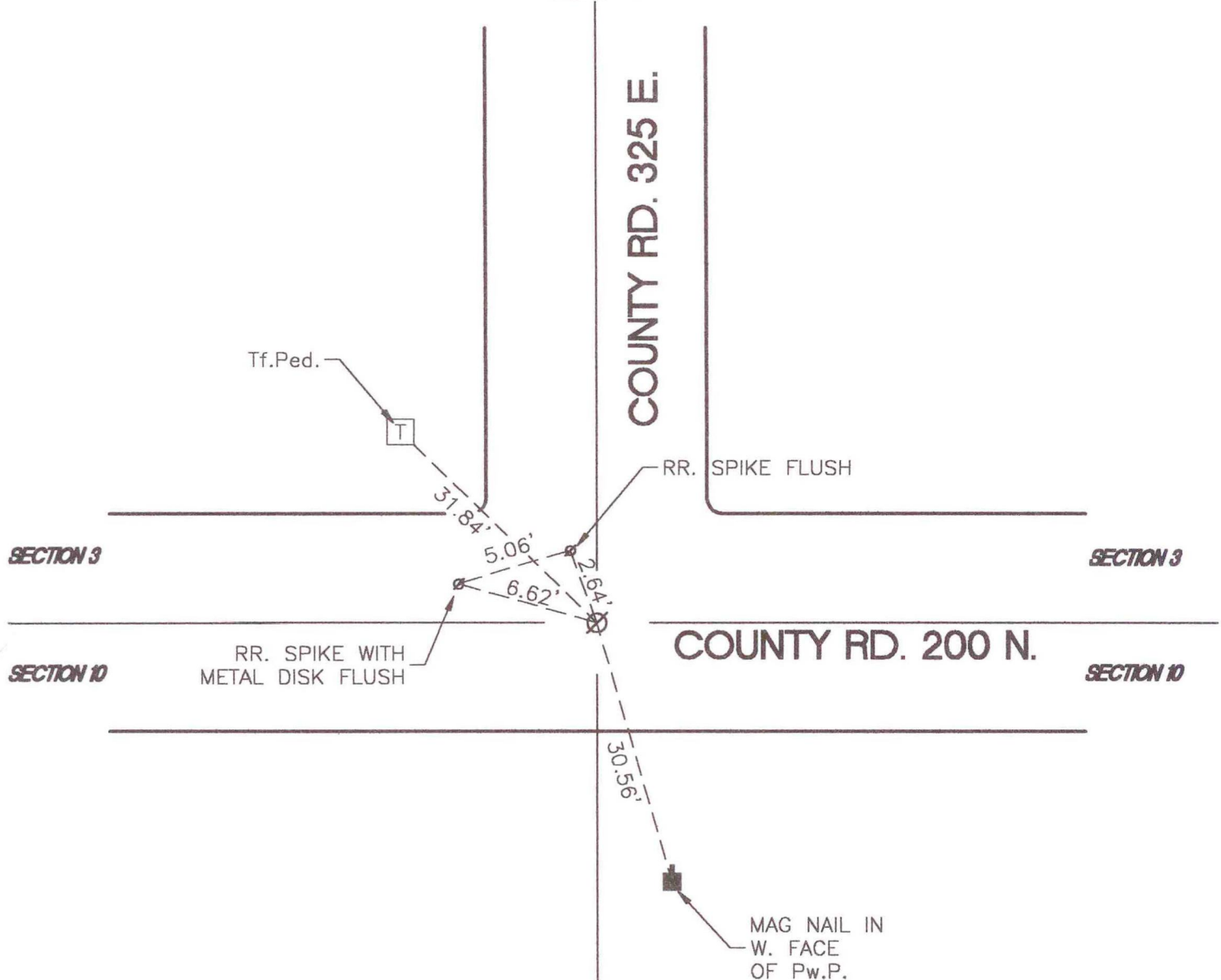

MONUMENT: RAILROAD SPIKE

CORNER OF: RECORD ☐ USE ☒

PARTY: HJC\VHJ\DPS

DATE: 12-13-2001

COMMENTS: 0.2' BELOW GRADE
SECTION CORNER SHOULD AGREE WITH A
MINOR SUBDIVISION KNOWN AS PLEASANT ACRES
1st ADDITION, ON THE WEST SIDE OF
COUNTY ROAD 325 EAST

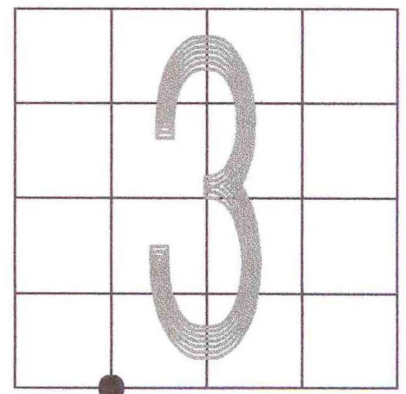

CORNER LOCATION IN THE SECTION