

# CALIFORNIA TOWNSHIP

T 32 N, R 2 W

## G3

SECTION 7

SECTION 7

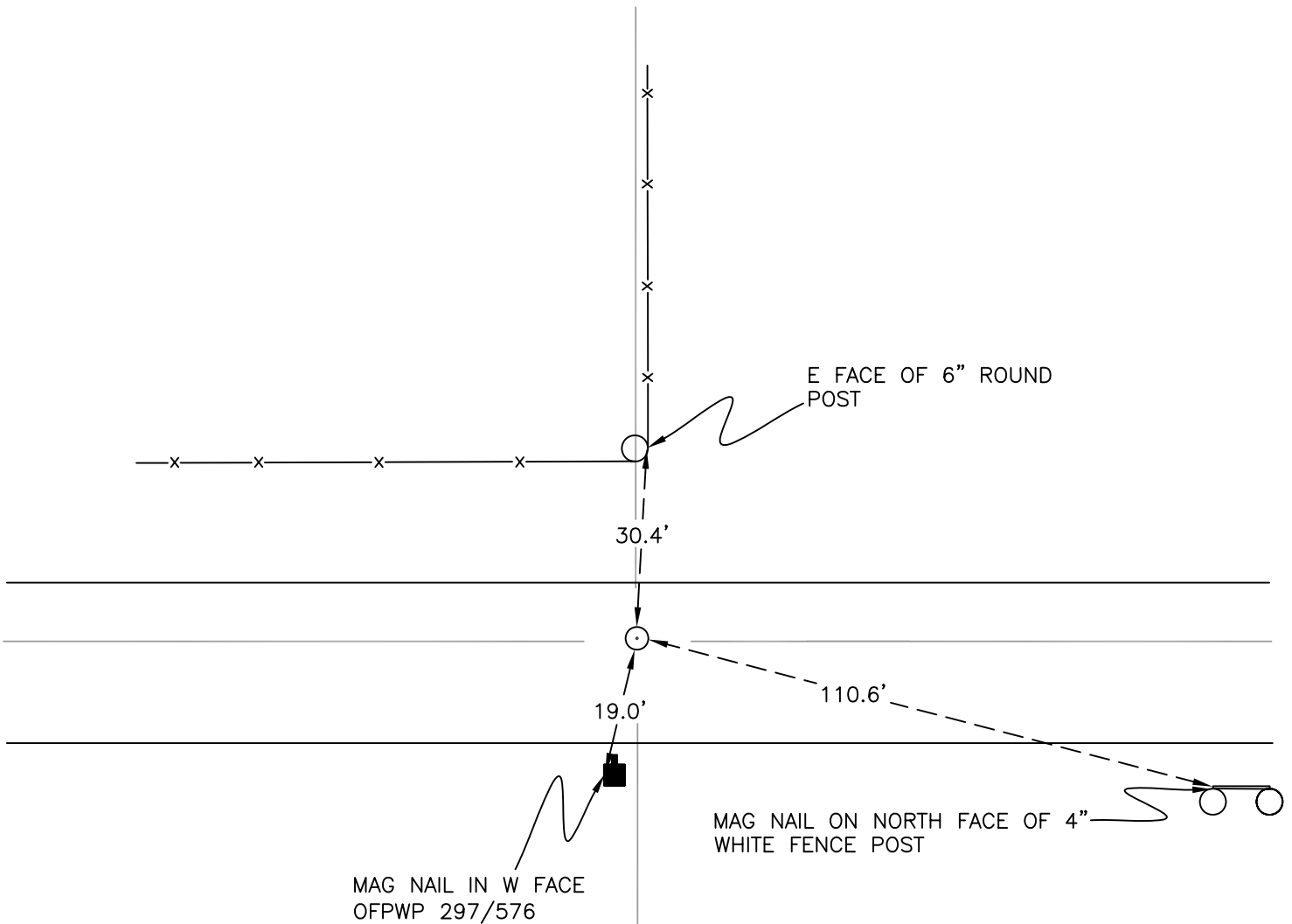

SECTION 7

SECTION 7

MONUMENT: RAIL BOLT

PARTY: JL/AO

DATE: 7/23/12

COMMENTS: 4' N OF  $\odot$  OF 450 S.  
CORNER OF USE BY GRAND KANKAKEE  
SURVEY IN DOCUMENT # 2006002771.

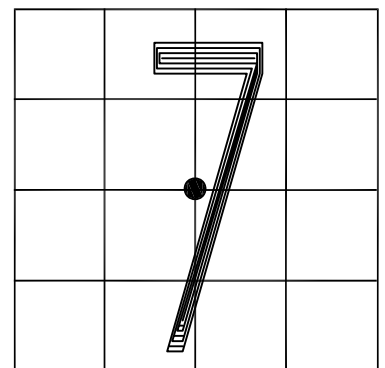

CORNER LOCATION IN THE SECTION

## G3