

# WAYNE TOWNSHIP

T 32 N, R 3 W

## L13

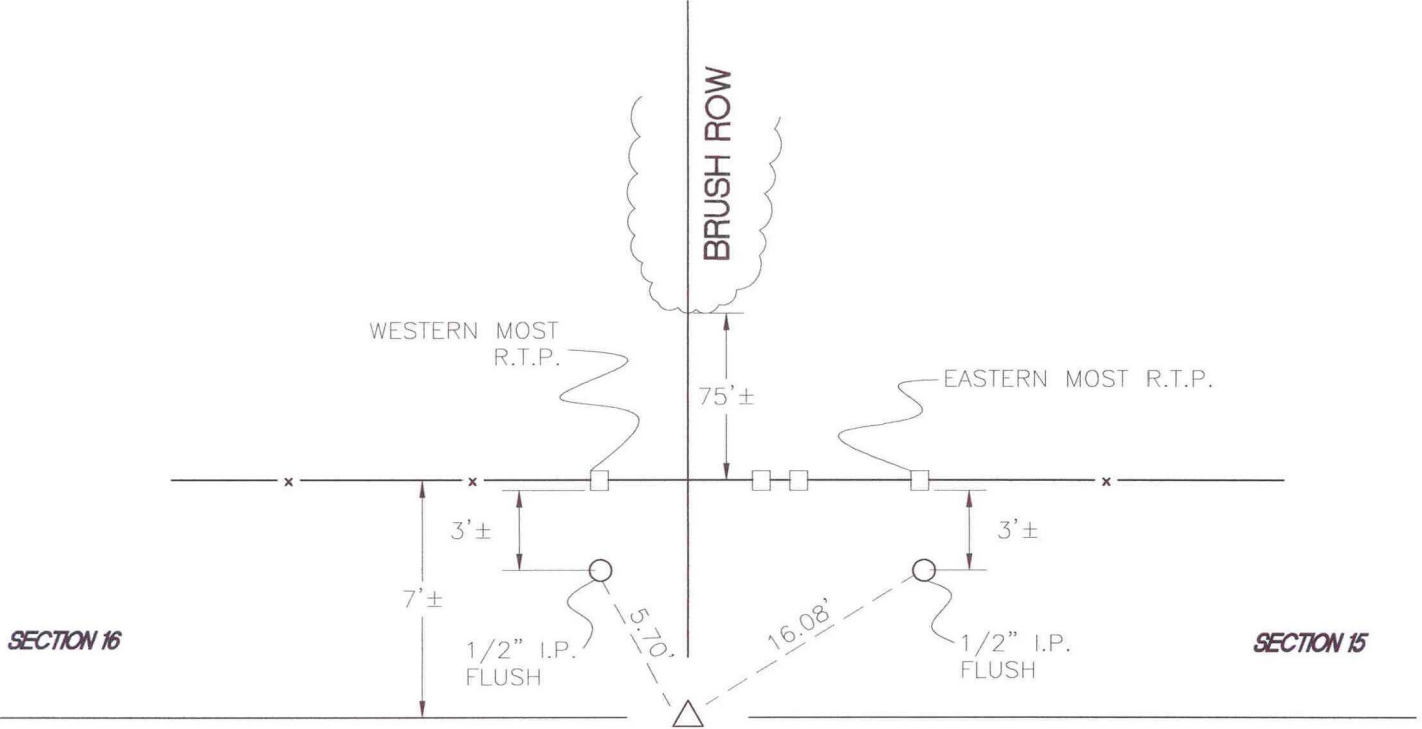

SECTION 16

SECTION 15

OPEN FIELD

OPEN FIELD

MONUMENT: (SEE COMMENTS)

CORNER OF: RECORD  USE

PARTY: VHJ, COD

DATE: 2-12-04

COMMENTS:

(F) 1/2" I.R.R. W/ VHJ CAP#S0411 (BENT)  
RECENTERED ROD AND DROVE DOWN FLUSH

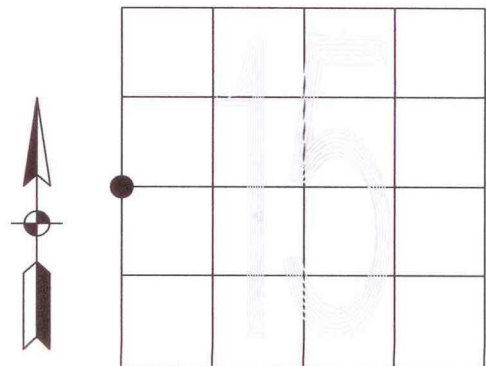

CORNER LOCATION IN THE SECTION