

SECTION CORNER REFERENCE

L15

L15

SECTION 15 TOWNSHIP 34-N RANGE 2-W
(Description of Corner Location) CENTER OF SECTION
DAVIS TWP.,
STARKE COUNTY, INDIANA

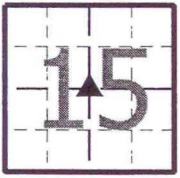

COORDINATES
 NAD '83 IN E. ZONE
 NAD '83 IN W. ZONE
 LOCAL GRID
Units: US FEET
Pt.#: 0062
N: 14,544.932
E: 7,351.086

TYPE OF MON.: RAILROAD RAIL
DEPTH: 4' HIGH
UNCERTAINTY:
BY: LAPORTE SURVEY
DATE: SEPTEMBER 2009
DES.NO.: 0500068

STATE FORM 40180 (R2/2-04)

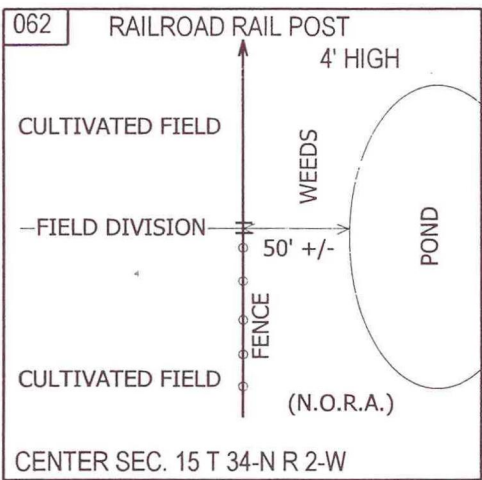

REFERENCED BY: INDOT

COMMENTS: MONUMENT NOT PREVIOUSLY RECORDED IN SURVEYOR'S OFFICE
NEEDS TO BE VERIFIED BY SURVEY.

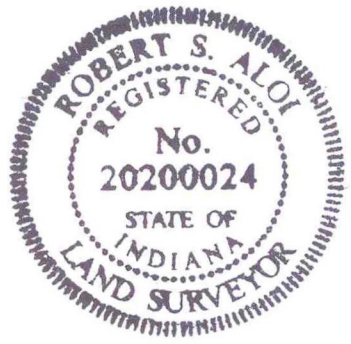

L15