

# WASHINGTON TOWNSHIP

T 33 N, R 1 W

## N19

SECTION 14

SECTION 14

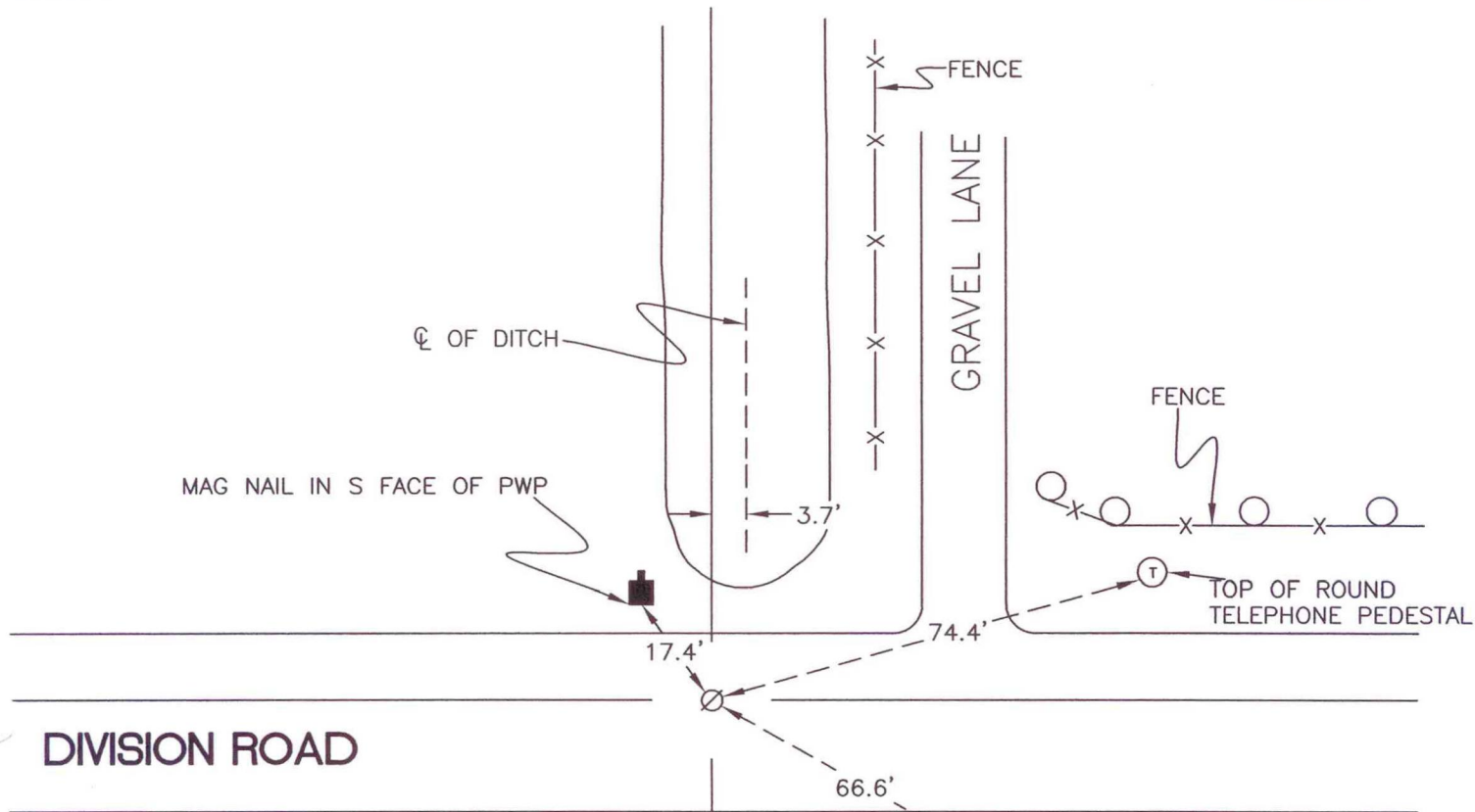

**DIVISION ROAD**

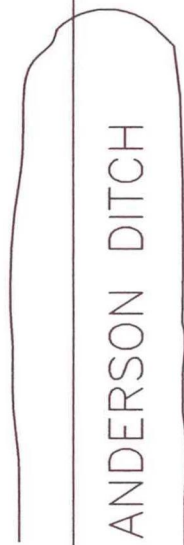

SECTION 23

SECTION 23

MONUMENT: RAILROAD SPIKE w/ PUNCH MARK

PARTY: DPS/JL

DATE: 11-3-2009

COMMENTS: MONUMENT IS 5.5' N OF ☉ OF DIVISION ROAD. USED BY WHIGHTMAN CRAMMER FOR SURVEYS IN 1997 AND 1998 AND TERRITORIAL ENGINEERING IN SURVEY # 08-216 AND 09-213.

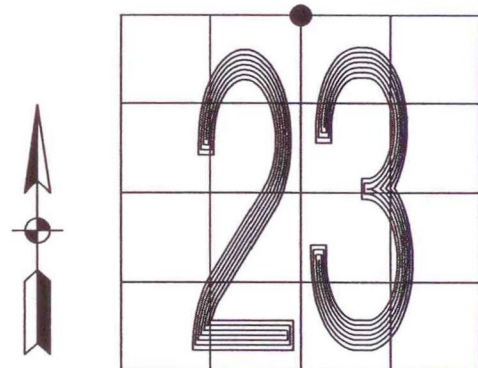

CORNER LOCATION IN THE SECTION

# N19