

DAVIS TOWNSHIP

T 34 N, R 2 W

N5

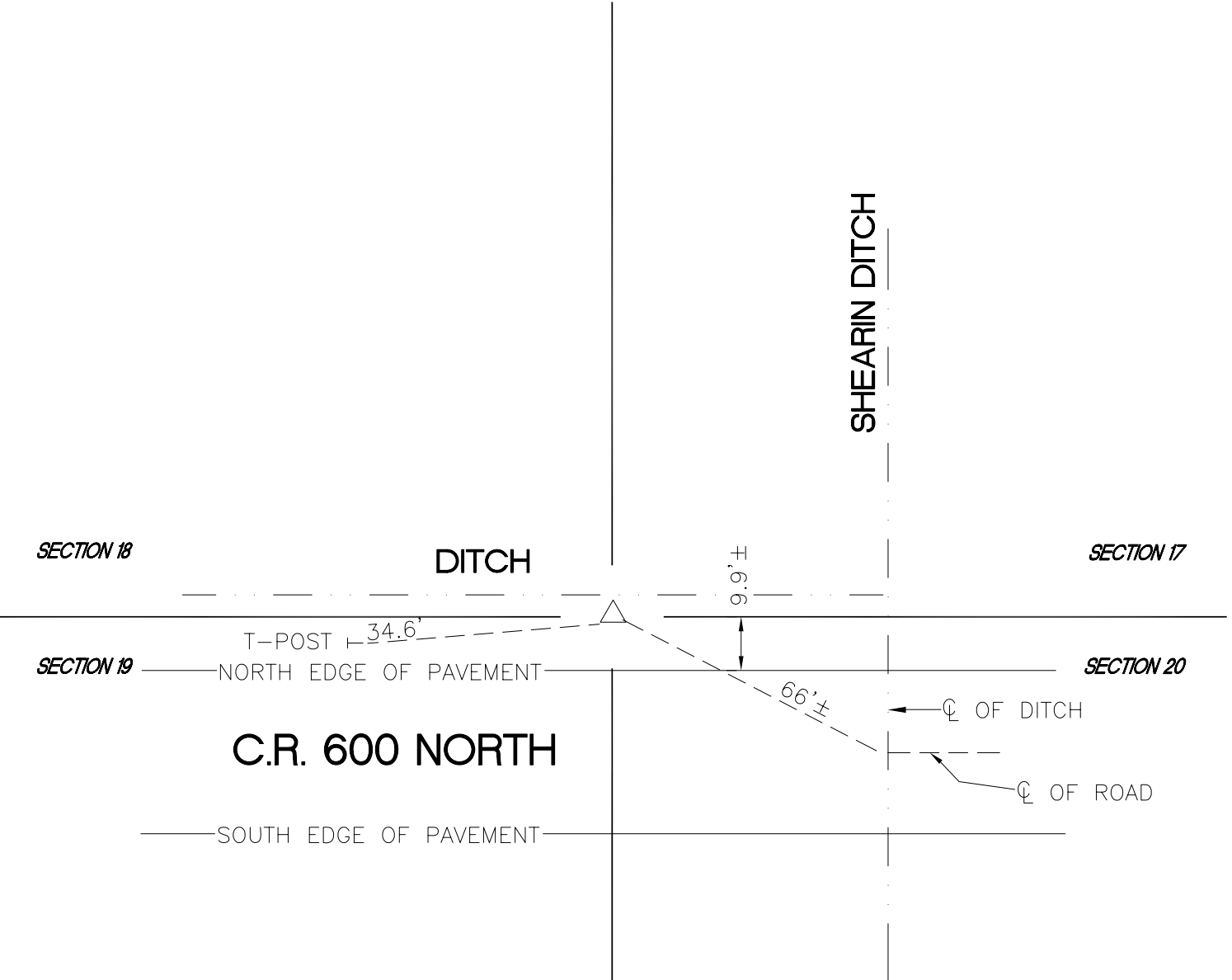

MONUMENT: 1" IRON PIPE AT TOE OF DITCH

CORNER OF: RECORD USE

PARTY: DPS/JL

DATE: 5-12-16

COMMENTS: SET BY DPS/GER IN 2005

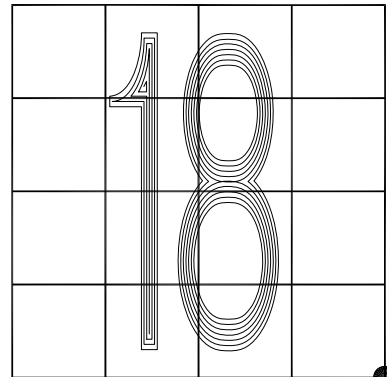
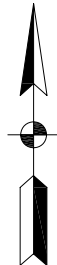

N5

CORNER LOCATION IN THE SECTION