

# DAVIS TOWNSHIP

T 34 N, R 2 W

## N7

SECTION 17

SECTION 17

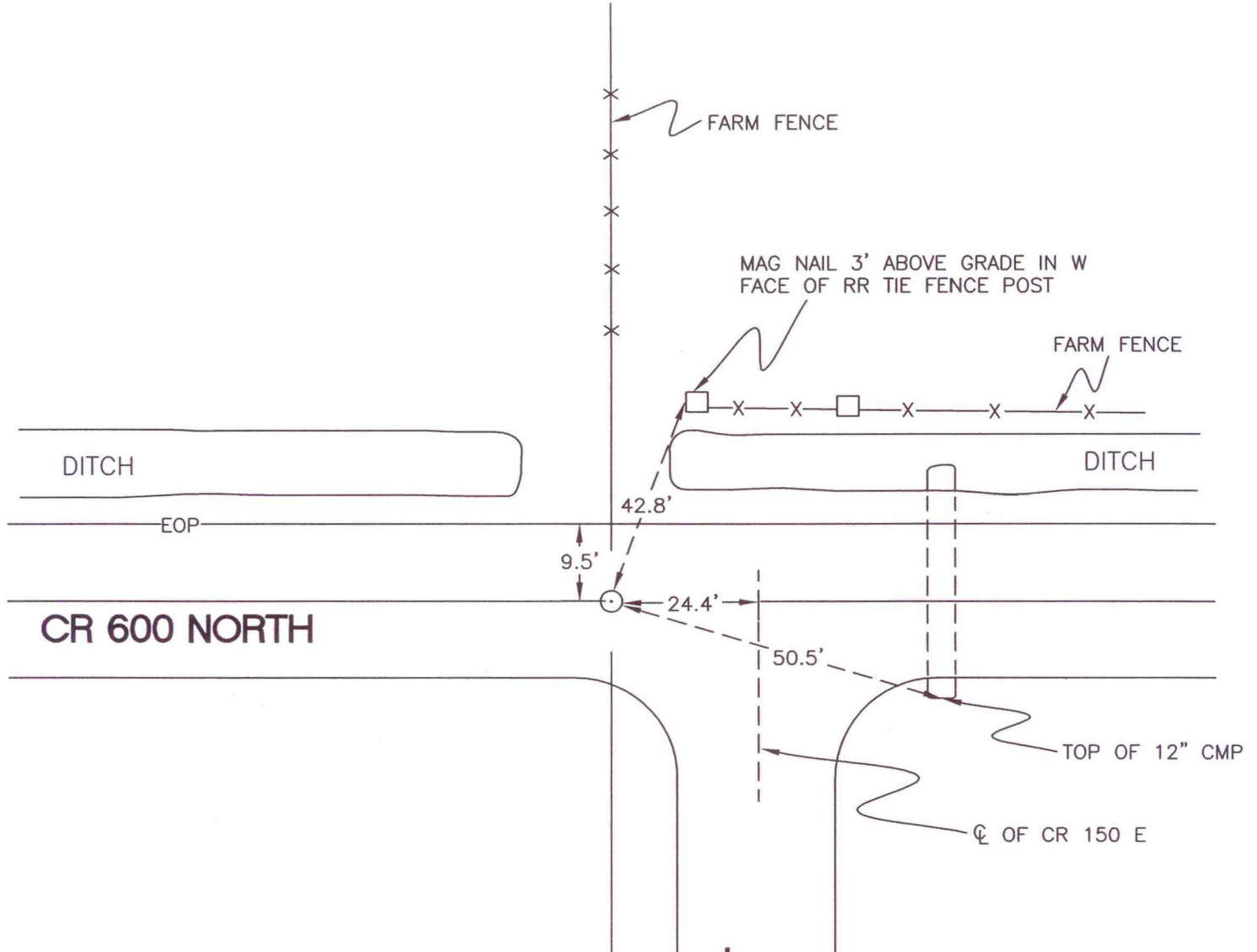

SECTION 20

MONUMENT: RAIL BOLT

PARTY: DPS/JL

DATE: 10/5/2009

COMMENTS: ESTABLISHED BY GRAND KANKAKEE SURVEY IN SURVEY # G02-180.

CR 150 EAST

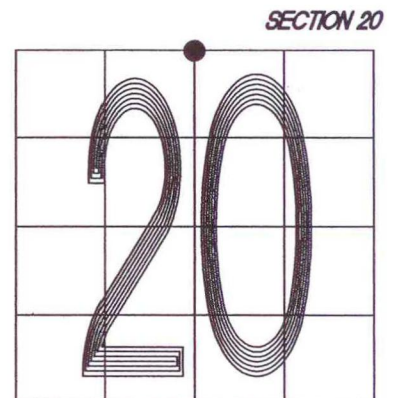

CORNER LOCATION IN THE SECTION

# N7