

# NORTH BEND TOWNSHIP

T 32 N, R 1 W

## P1

SECTION 24  
CALIFORNIA TOWNSHIP

SECTION 19  
NORTH BEND TOWNSHIP

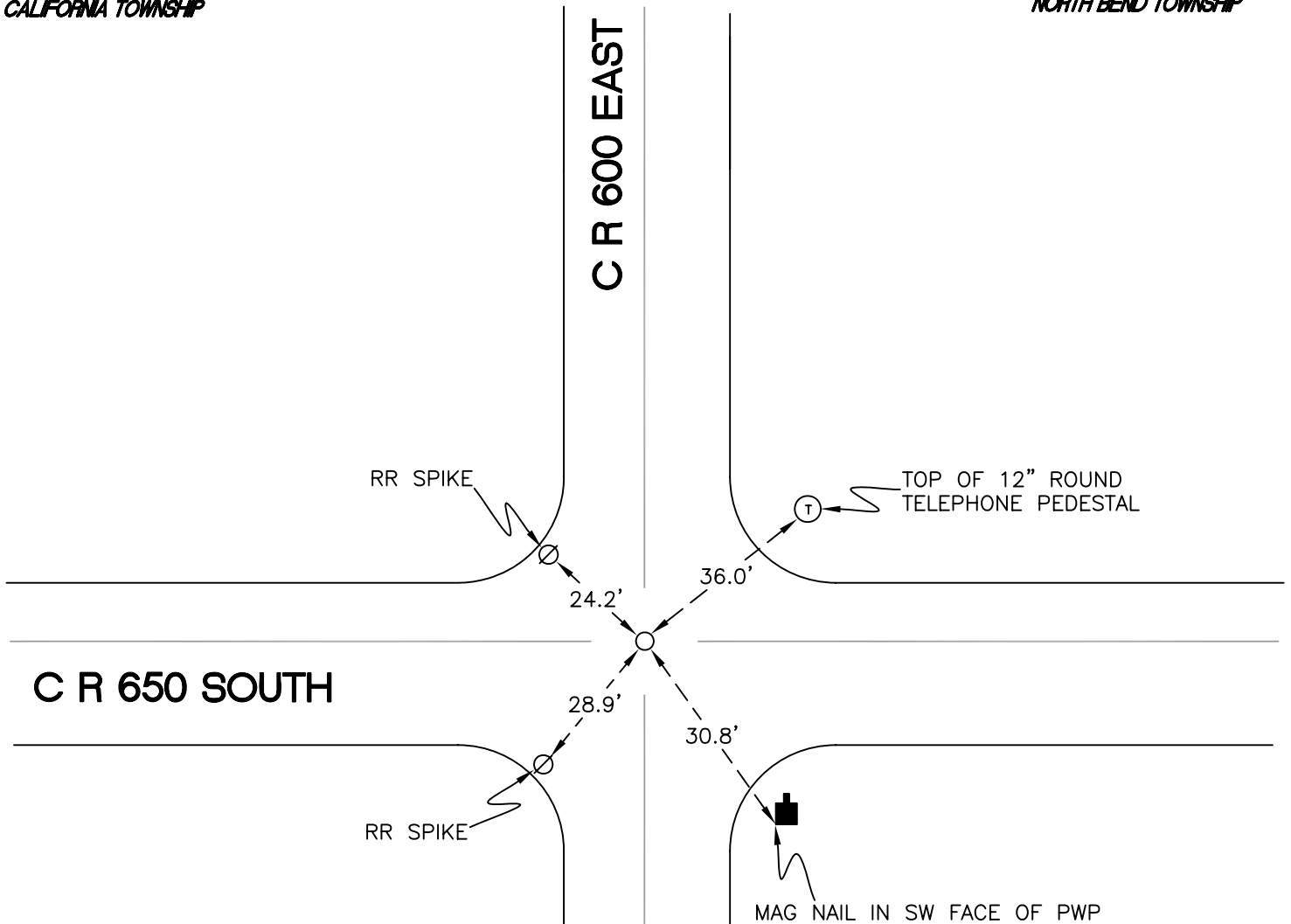

SECTION 24  
CALIFORNIA TOWNSHIP

SECTION 19  
NORTH BEND TOWNSHIP

MONUMENT: 1 1/2" IRON PIPE ABOVE STONE

PARTY: DPS/JL

DATE: 7/7/14

COMMENTS: 3' N OF  $\text{C}$  OF 650 S.  
STONE 10" BELOW GRADE. RESET PIPE  
ABOVE STONE AND CORRECT DISTANCE  
FROM SOLE REMAINING REFERENCE IN 2012. FOUND  
IN 1932 BY PAUL, 1950 BY SMRT, 1981 BY  
VHJ, 1984 BY RLP, AND 2012 BY DPS/JL/AO,

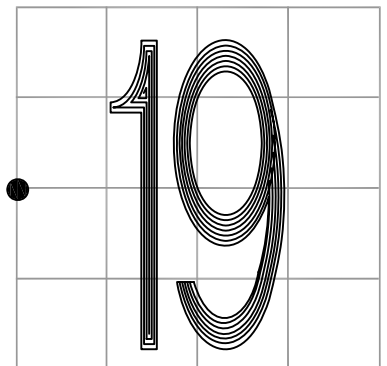

CORNER LOCATION IN THE SECTION

## P1