

# WASHINGTON TOWNSHIP

T 33 N, R 1 W

## P19

SECTION 23

SECTION 23

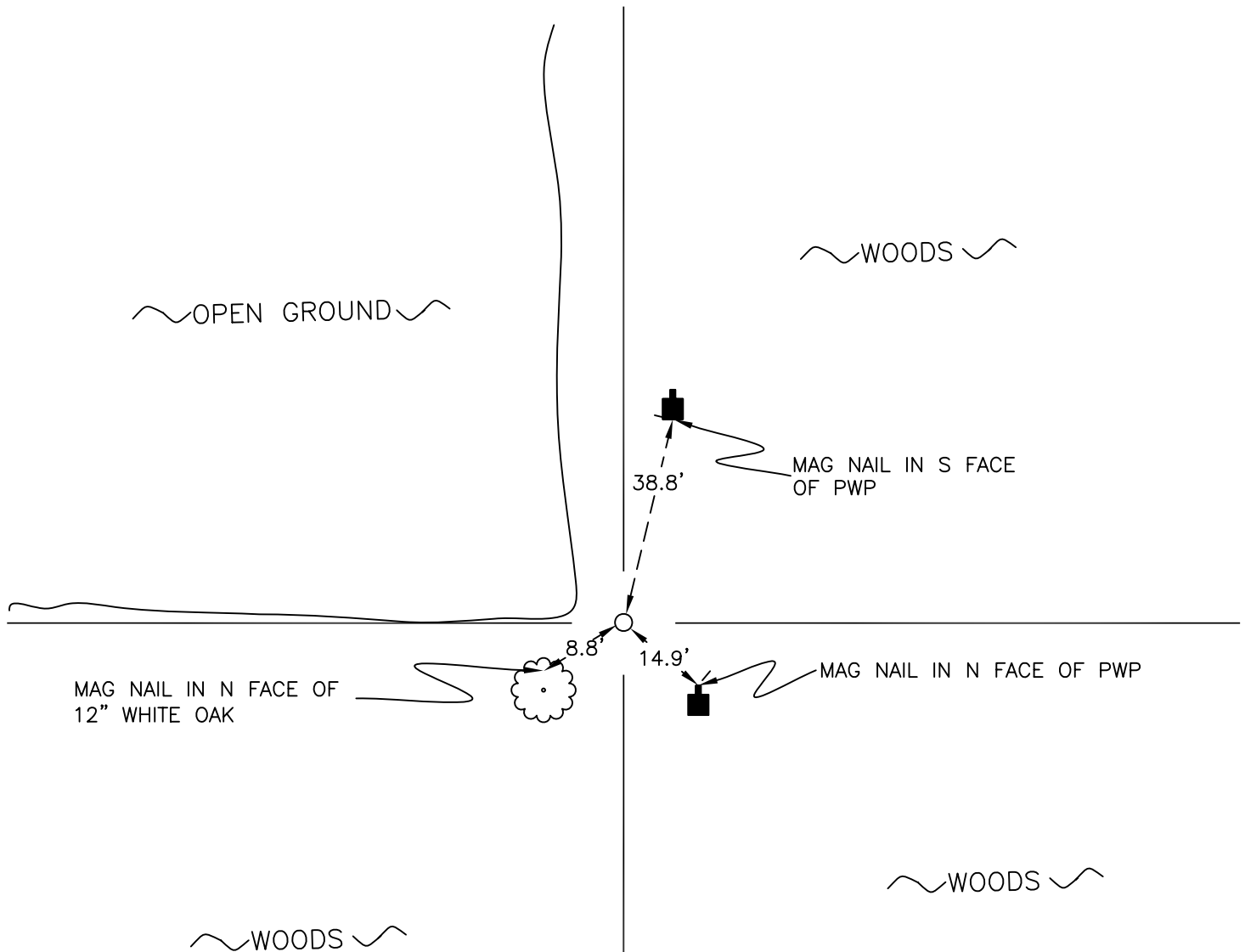

SECTION 23

SECTION 23

MONUMENT: 3/4" IRON PIPE w/ PLASTIC CAP

CORNER OF: RECORD  USE

PARTY: JL/PM

DATE: 6-18-2008

COMMENTS: 4" ABOVE GRADE  
USED AS CENTER OF SECTION BY WIGHTMAN-CRAMER  
AND TERRITORIAL ENGINEERING.

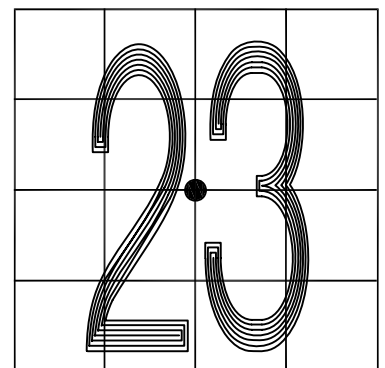

CORNER LOCATION IN THE SECTION

# P19