

CALIFORNIA TOWNSHIP

T 32 N, R 2 W

P25

SECTION 24
CALIFORNIA TOWNSHIP

SECTION 19
NORTH BEND TOWNSHIP

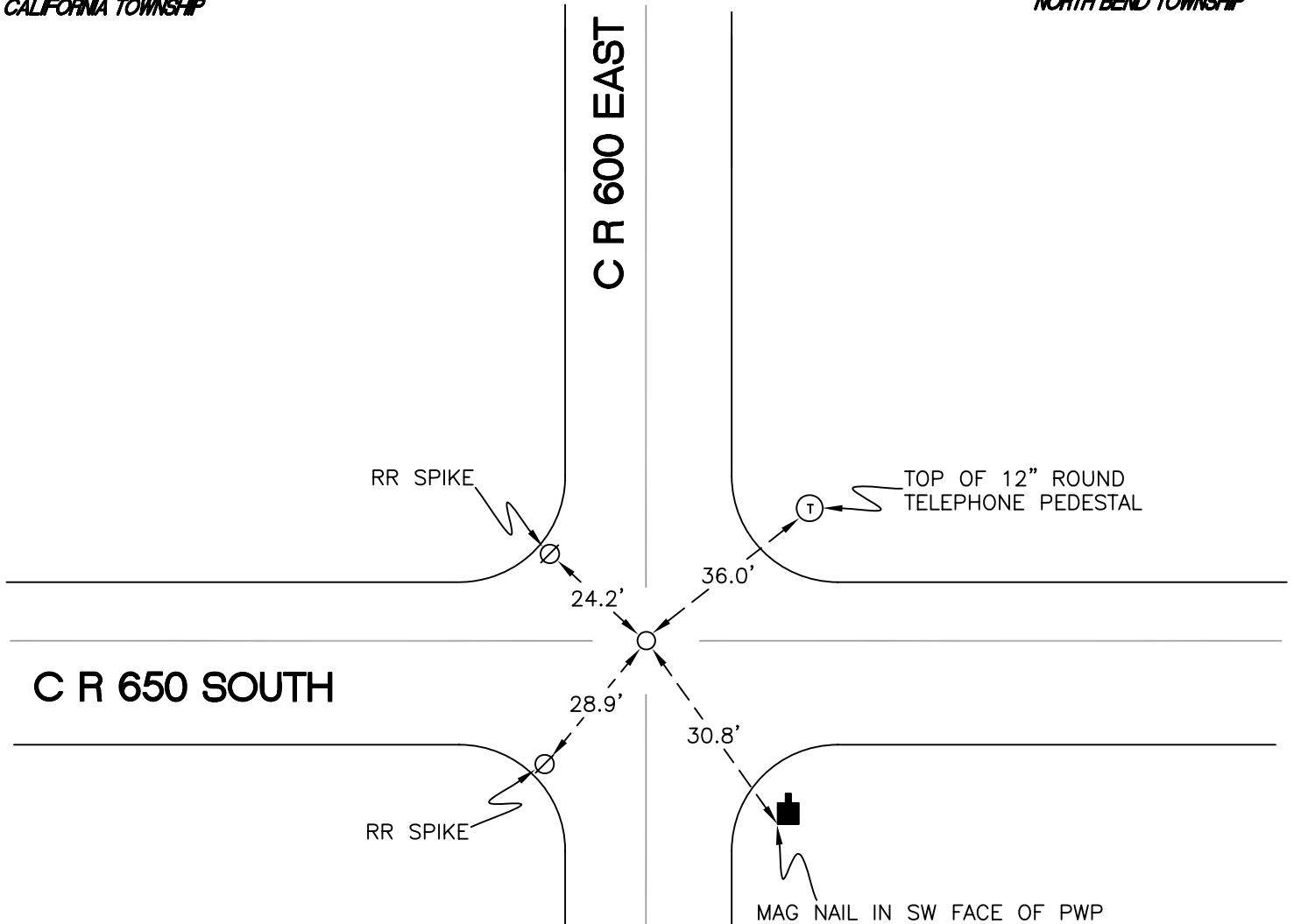

SECTION 24
CALIFORNIA TOWNSHIP

SECTION 19
NORTH BEND TOWNSHIP

MONUMENT: 1 1/2" IRON PIPE ABOVE STONE

PARTY: DPS/JL

DATE: 7/7/14

COMMENTS: 3' N OF C OF 650 S.
STONE 10" BELOW GRADE. RESET PIPE
ABOVE STONE AND CORRECT DISTANCE
FROM SOLE REMAINING REFERENCE IN 2012. FOUND
IN 1932 BY PAUL, 1950 BY SMRT, 1981 BY
VHJ, 1984 BY RLP, AND 2012 BY DPS/JL/AO,

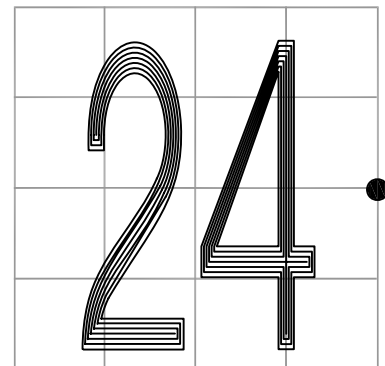

CORNER LOCATION IN THE SECTION

P25