

RAILROAD TOWNSHIP

T 32 N, R 4 W

R1

SECTION 24
KANKAKEE TOWNSHIP
JASPER COUNTY

SECTION 19
RAILROAD TOWNSHIP
STARKE COUNTY

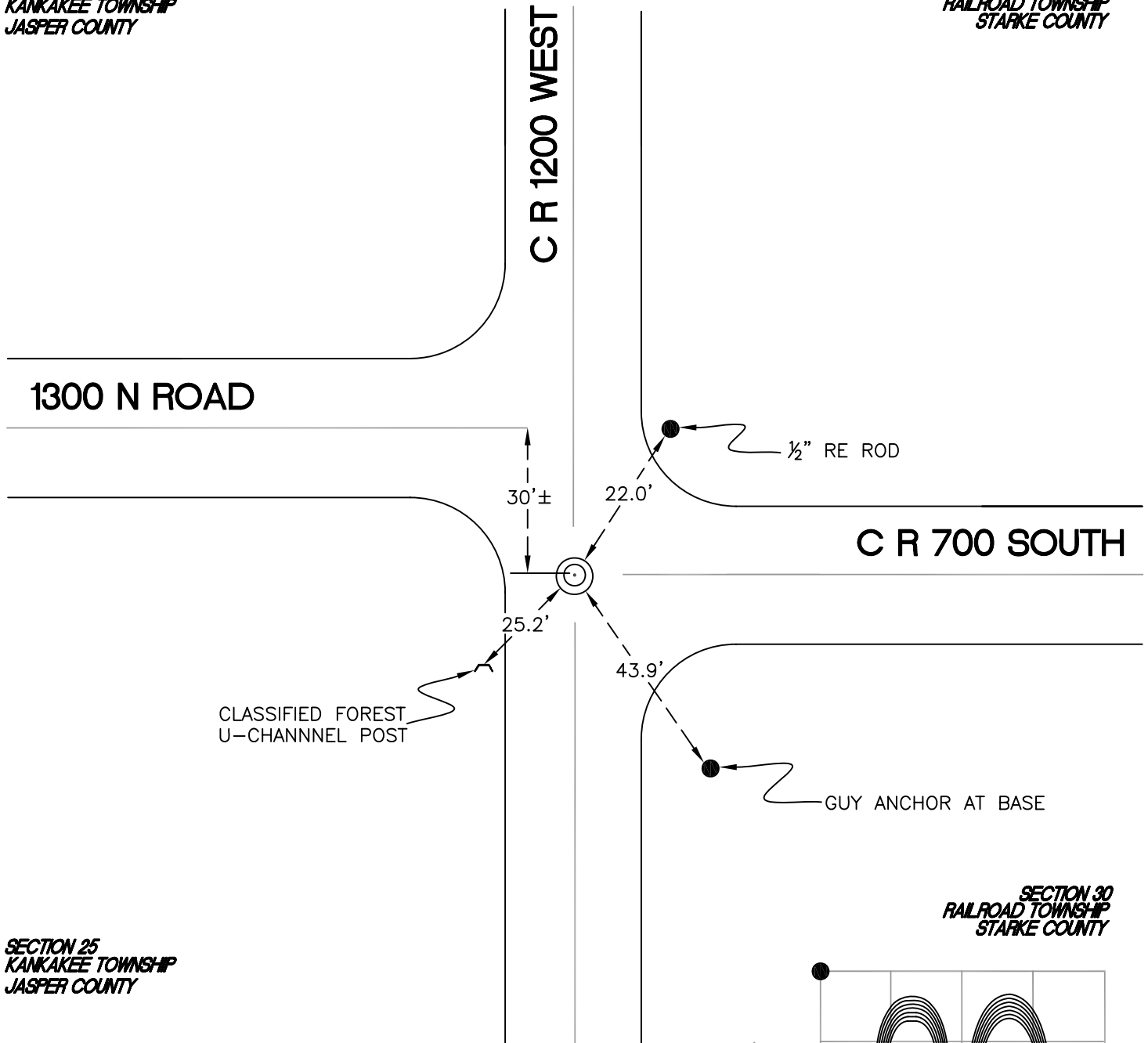

SECTION 25
KANKAKEE TOWNSHIP
JASPER COUNTY

SECTION 30
RAILROAD TOWNSHIP
STARKE COUNTY

MONUMENT: 2" IRON PIPE w/ RAIL BOLT IN CENTER

PARTY: DPS/REZ

DATE: 2015

COMMENTS: WOOD MONUMENT FOUND BY RLP/AW IN 1984.
RESET 2" IRON PIPE.

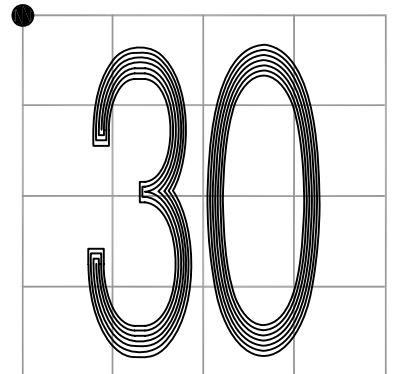

CORNER LOCATION IN THE SECTION

R1