

STARKE COUNTY SECTION CORNER RECORD

MONUMENT: RAILROAD X-BOLT

TOWNSHIP: JACKSON

PARTY: D.C.

DATE: 11-29-21

COMMENTS:

THIS CORNER WAS ESTABLISHED AND SET BY TERRITORIAL ENGINEERING IN A SURVEY FOR GUMZ, JOB #20-204.

STATE PLANE COORDINATES

DATUM: NAD83

ZONE: 17N 12E 13E

NORTHING: 2200213.552

EASTING: 3058527.568

NOTE:

COORDINATES BASED ON INCORS NETWORK FOR GENERAL REFERENCE PURPOSES ONLY AND SHALL NOT BE USED FOR BOUNDARY SURVEY PURPOSES. STARKE COUNTY DOES NOT WARRANT OR GUARANTEE THE ACCURACY OF THIS DATA AND DISCLAIMS ANY RESPONSIBILITY OR LIABILITY FOR INTERPRETATIONS BASED ON USING THIS DATA FOR BOUNDARY DECISIONS.

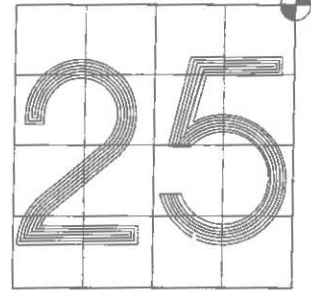

LATITUDE: 41°17'17.25"N

LONGITUDE: 86°41'54.41"W

SEC.25-T33N-R3W

SECTION 24
JACKSON TOWNSHIP

SECTION 19
CENTER TOWNSHIP

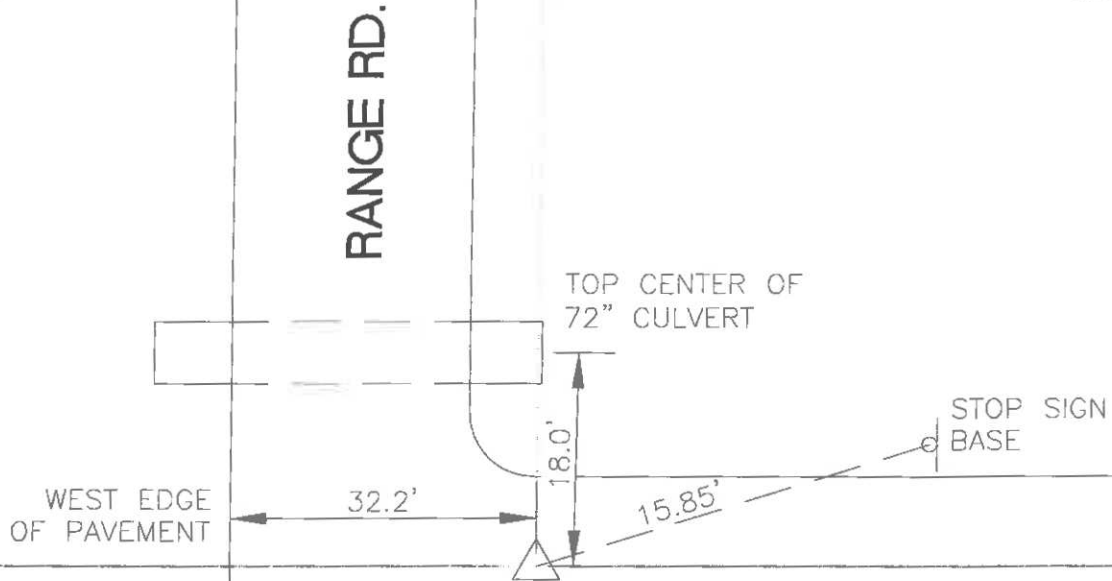

SECTION 25
JACKSON TOWNSHIP

SECTION 30
CENTER TOWNSHIP

R25