

STARKE COUNTY SECTION CORNER RECORD

MONUMENT: RR BOLT (0.3BG)

TOWNSHIP: OREGON

PARTY: DDC

DATE: 5/24/2021

COMMENTS:

NONE.

STATE PLANE COORDINATES

DATUM: NAD83

ZONE: INDIANA WEST 1302

NORTHING: 2232076.0560

EASTING: 3092952.7730

NOTE:

COORDINATES BASED ON INCORS NETWORK FOR GENERAL REFERENCE PURPOSES ONLY AND SHALL NOT BE USED FOR BOUNDARY SURVEY PURPOSES. STARKE COUNTY DOES NOT WARRANT OR GUARANTEE THE ACCURACY OF THIS DATA AND DISCLAIMS ANY RESPONSIBILITY OR LIABILITY FOR INTERPRETATIONS BASED ON USING THIS DATA FOR BOUNDARY DECISIONS.

LATITUDE: 41°22'30.28928"N

LONGITUDE: 86°34'20.96156"W

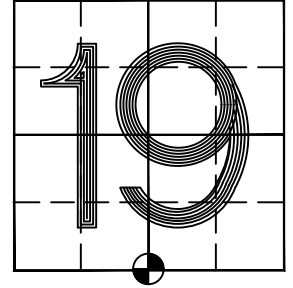

SEC.19-T34N-R1W

SECTION 19

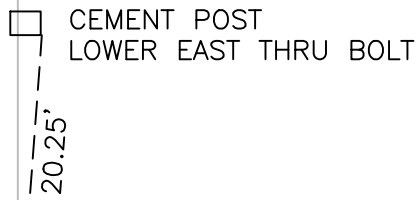
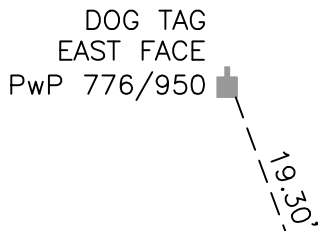

C.R. 500 NORTH

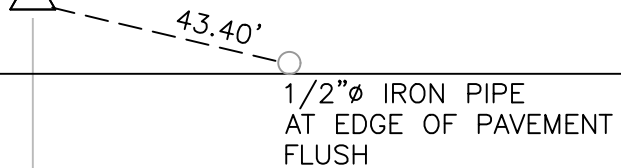

SECTION 30

SECTION 30

R3