

# CALIFORNIA TOWNSHIP

T 32 N, R 2 W

## R5

SECTION 19

SECTION 20

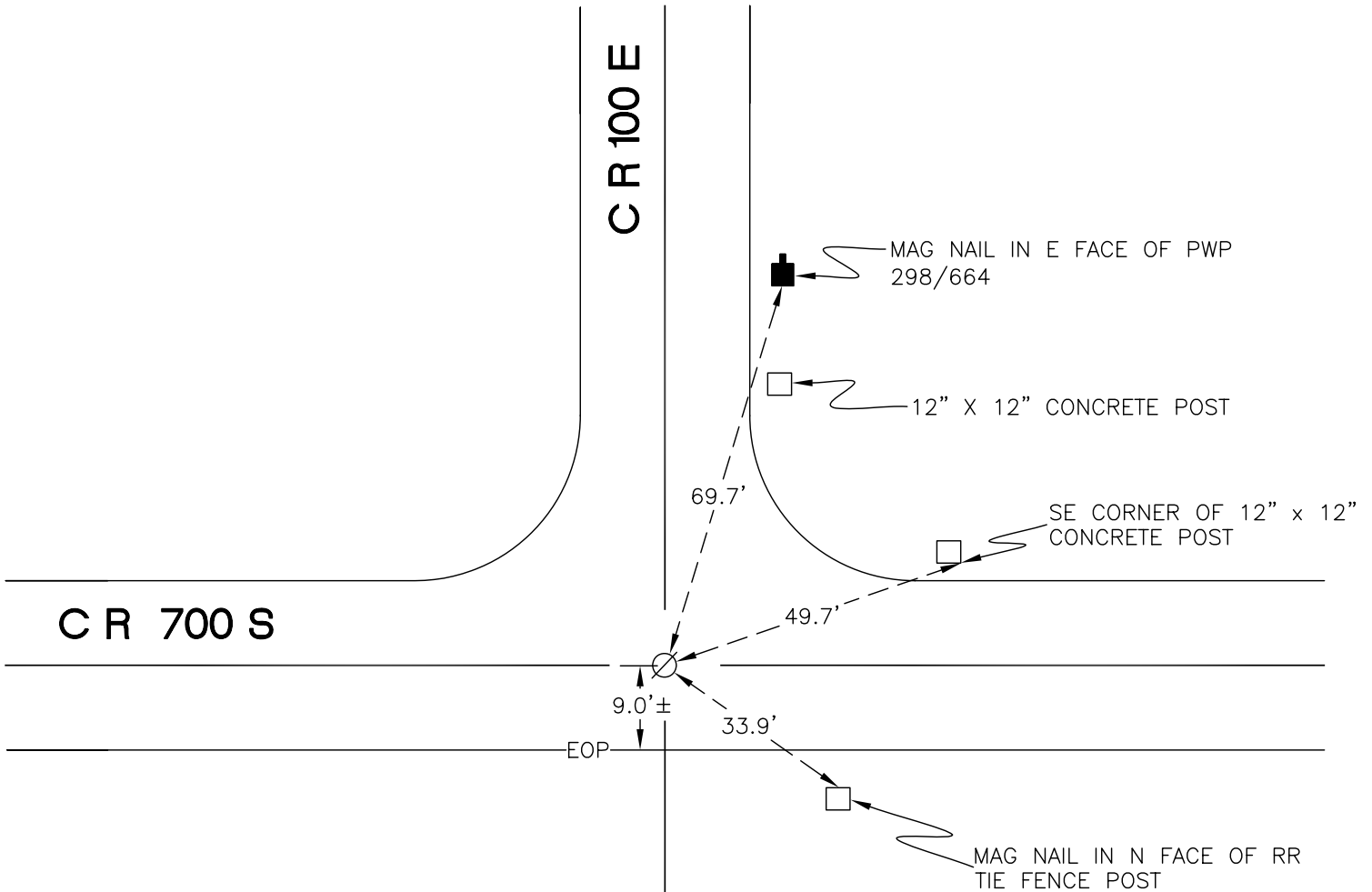

SECTION 30

SECTION 29

MONUMENT: RAILROAD SPIKE

PARTY: DPS/JL

DATE: 5-3-2010

COMMENTS: MONUMENT WAS USE BY WHIGHTMAN CRAMER IN SURVEY # 97074 AND TERRITORIAL ENGINEERING IN SURVEY # 10-139. MONUMENT IS 8" BELOW GRADE.

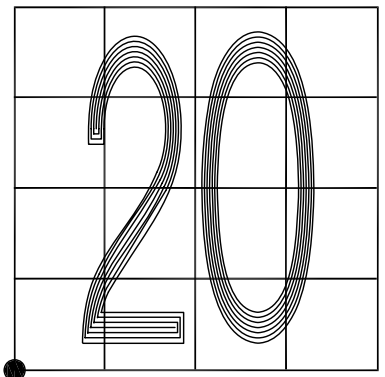
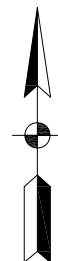

CORNER LOCATION IN THE SECTION

## R5