

CALIFORNIA TOWNSHIP

T 32 N, R 2 W

R5

SECTION 19

SECTION 20

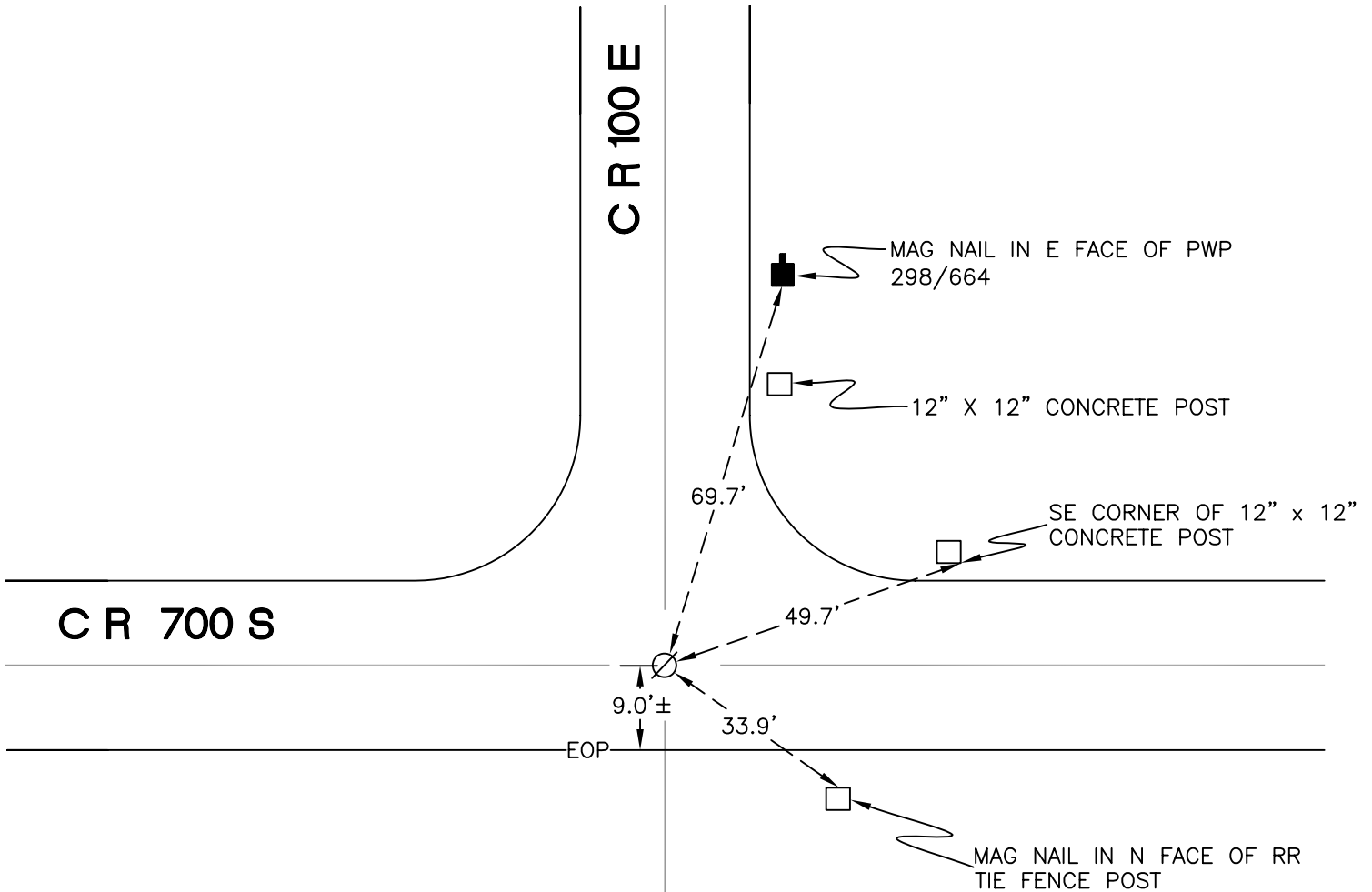

SECTION 30

SECTION 29

MONUMENT: RAILROAD SPIKE

PARTY: DPS/JL

DATE: 7-15-2014

COMMENTS: MONUMENT WAS USED IN SURVEYS BY WIGHTMAN CRAMER AS SHOWN IN DEED RECORD MM 651 AND TERRITORIAL ENGINEERING AS SHOWN IN DOCUMENT # 2010002803. MONUMENT IS 8" BELOW GRADE,

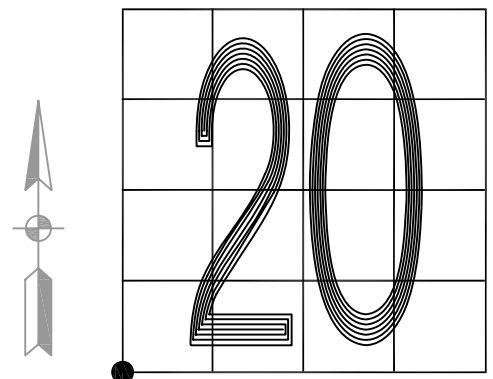

CORNER LOCATION IN THE SECTION

R5