

RAILROAD TOWNSHIP

T 32 N, R 4 W

C9

SECTION 5

SECTION 4

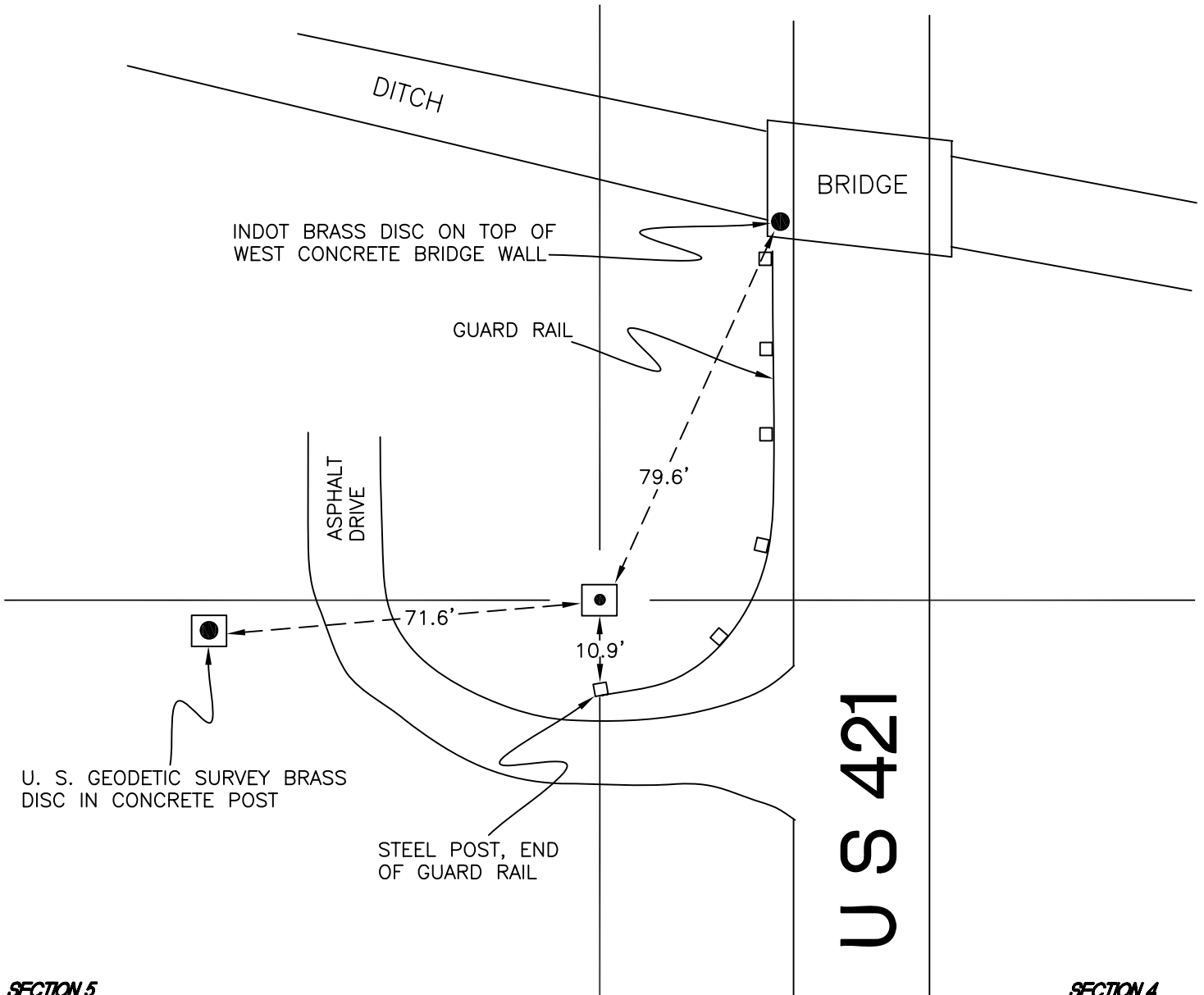

SECTION 5

SECTION 4

MONUMENT: 1" BRASS ROD IN 4"x4" CONCRETE
CORNER OF: RECORD USE
PARTY: JL/PM
DATE: 4-3-2008
COMMENTS: LOCATED IN 1988. INFO ON LOCATION CAME FROM INDOT.

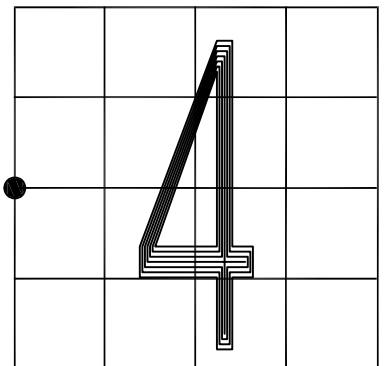

CORNER LOCATION IN THE SECTION

C9