

# RAILROAD TOWNSHIP

T 32 N, R 4 W

## G21

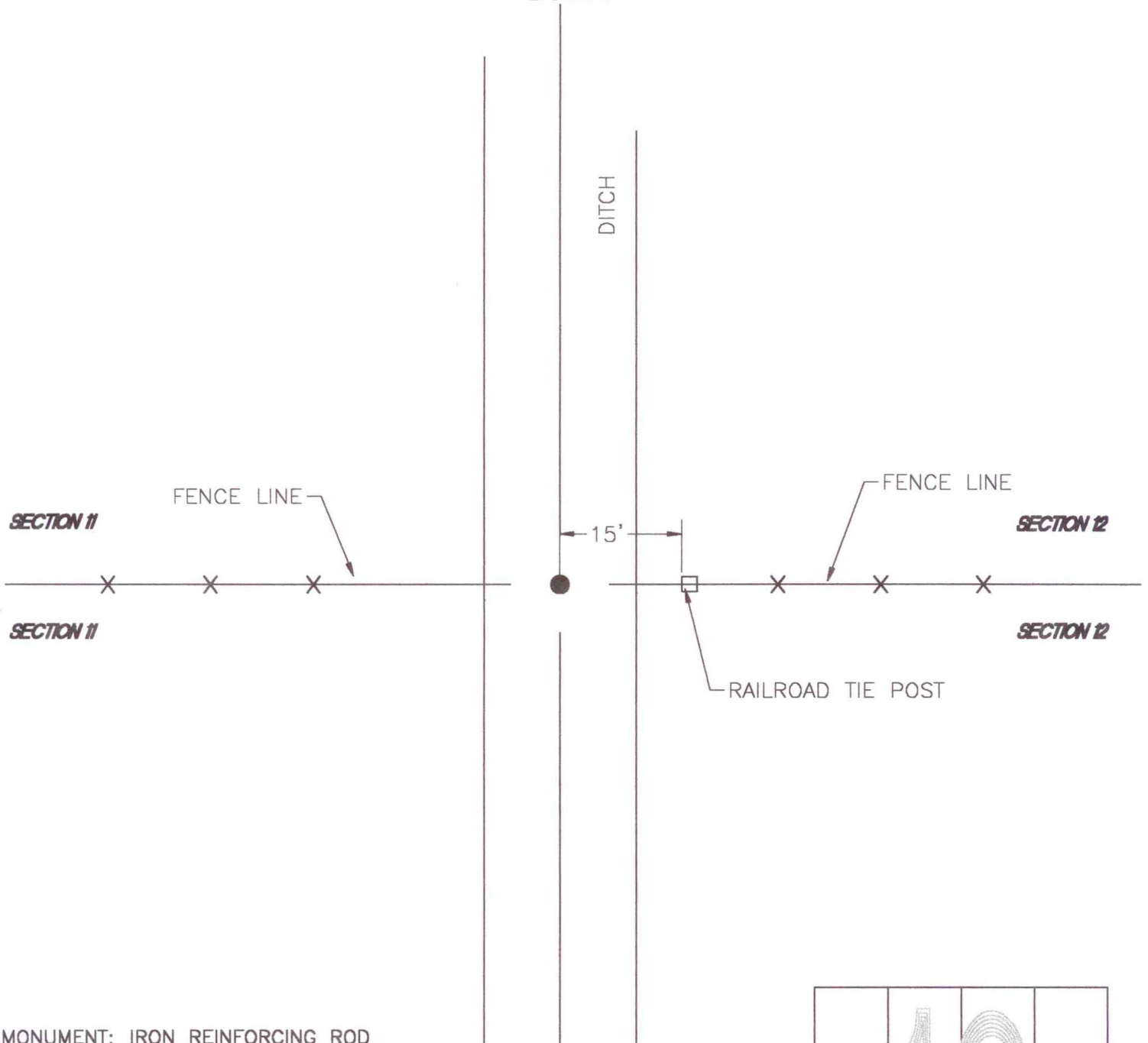

MONUMENT: IRON REINFORCING ROD

CORNER OF: RECORD  USE

PARTY: DWC

DATE: 3/16/2000

COMMENTS: ON CENTERLINE OF DITCH

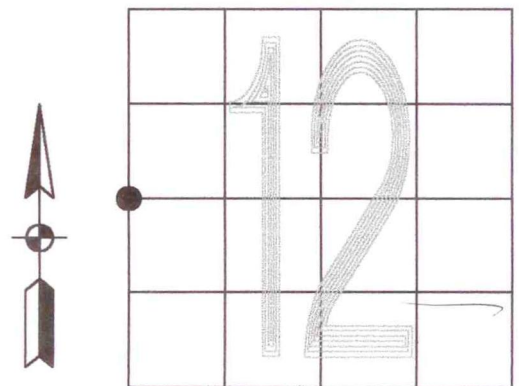

CORNER LOCATION IN THE SECTION