

RAILROAD TOWNSHIP

T 32 N, R 4 W

JASPER CO.
KANKAKEE TWP.

SECTION 13

SECTION 18

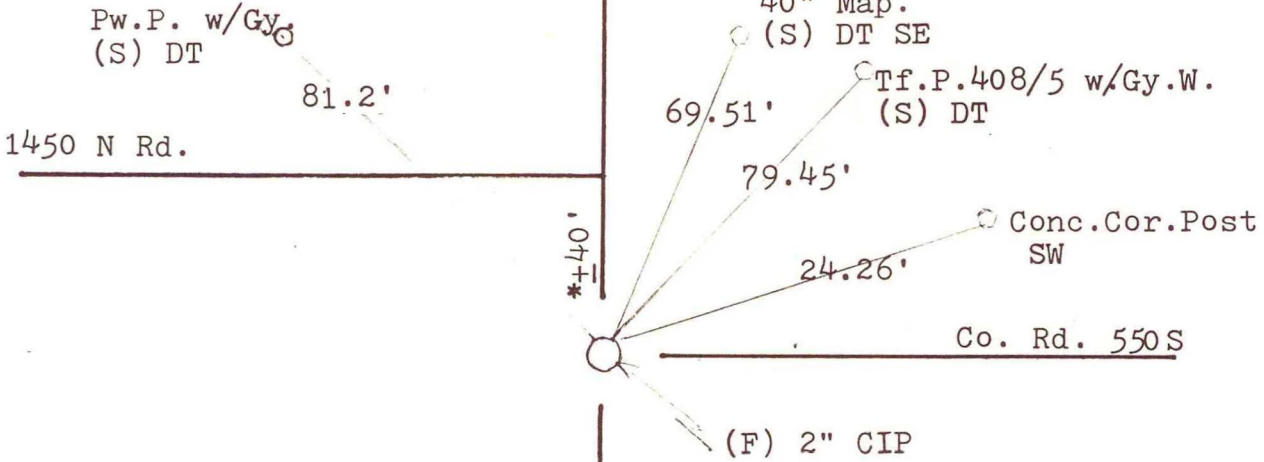

REM: * Offset between Starke County Road 550 S & Jasper County Road 1450 N, $\pm 40'$ scaled from aerial photo.

JASPER CO.
KANKAKEE TWP.

SECTION 13

SECTION 18

Co. Rd. 1200 W

DATE	BY	DATE	BY
28Jun1984	RLP		

CORNER OF: RECORD USE

SOURCE OF INFORMATION:

Field Book M-9, page 8

L-1