

RAILROAD TOWNSHIP

T 32 N, R 4 W

SECTION 36 Kankakee Twp.
Jasper Co.

SECTION 31

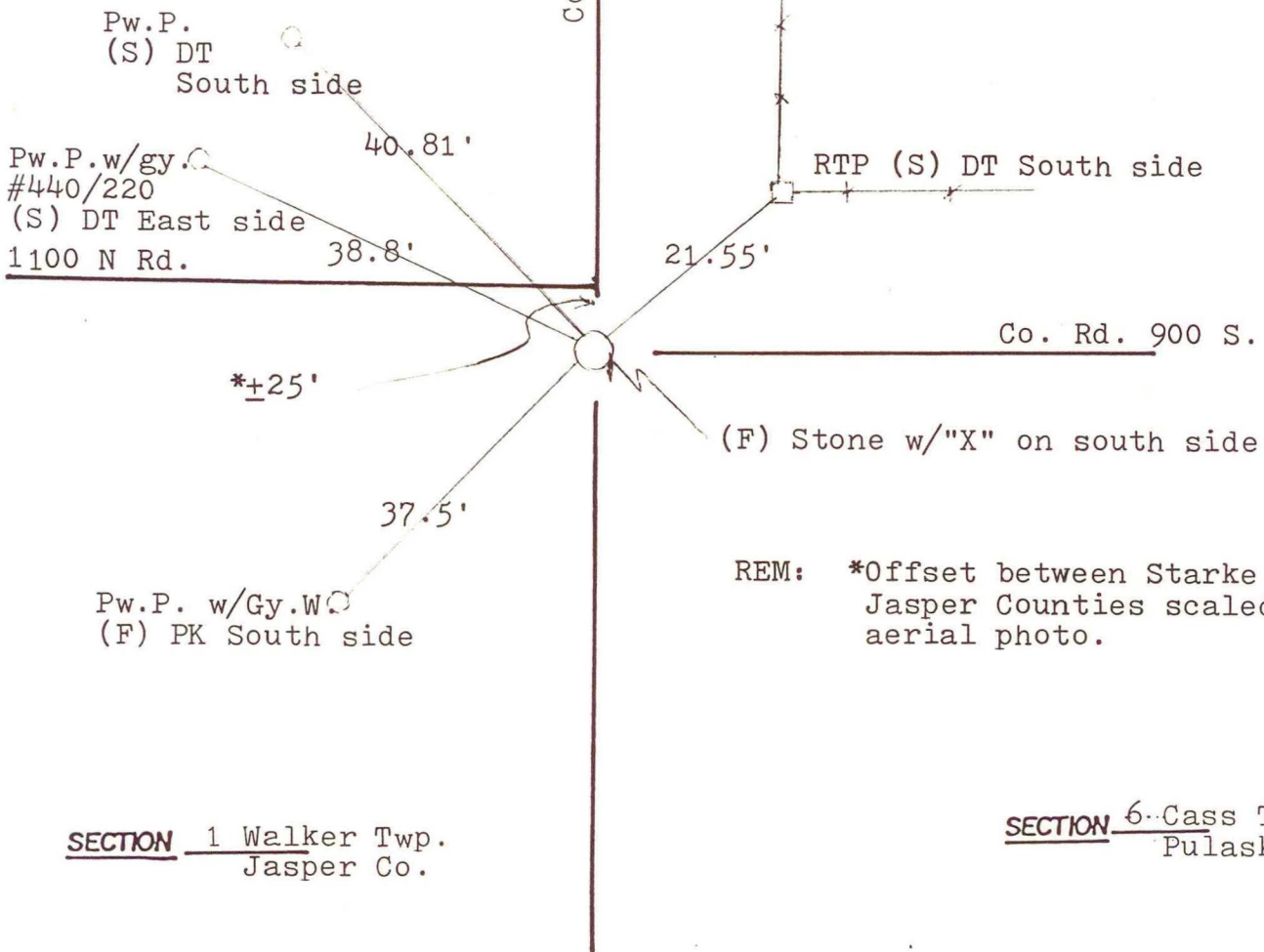

SECTION 1 Walker Twp.
Jasper Co.

SECTION 6 Cass Twp.
Pulaski Co.

REM: *Offset between Starke & Jasper Counties scaled from aerial photo.

DATE	BY	DATE	BY
25Apr1984	RLP/AW		

CORNER OF: RECORD USE

SOURCE OF INFORMATION:

Field Book M-2, page 23