

NORTH BEND TOWNSHIP

T 32 N, R 1 W

T23

SECTION 25

SECTION 25

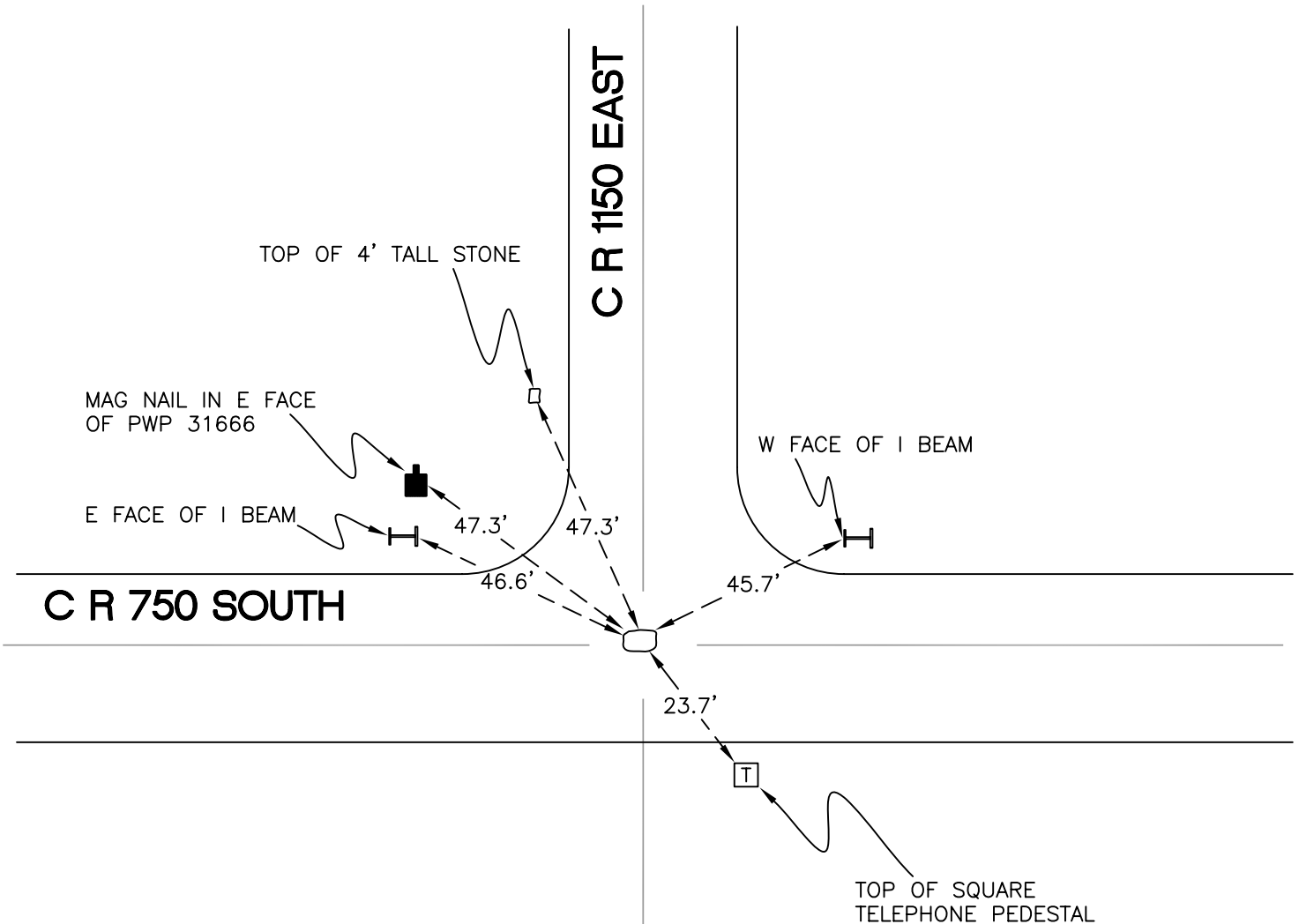

SECTION 25

SECTION 25

MONUMENT: 12" STONE

PARTY: JL/AO

DATE: 6/13/12

COMMENTS: 1' N OF C OF 750 S; 1' W OF C OF 1150 E.
RAIL BOLT LAID ON TOP OF STONE. STONE SET IN 1898; FOUND IN 1975 BY RTB AND IN 1977 BY CMS.

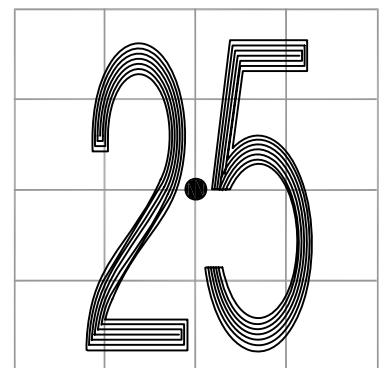

CORNER LOCATION IN THE SECTION

T23