

NORTH BEND TOWNSHIP

T 32 N, R 1 W

T5

SECTION 30

SECTION 29

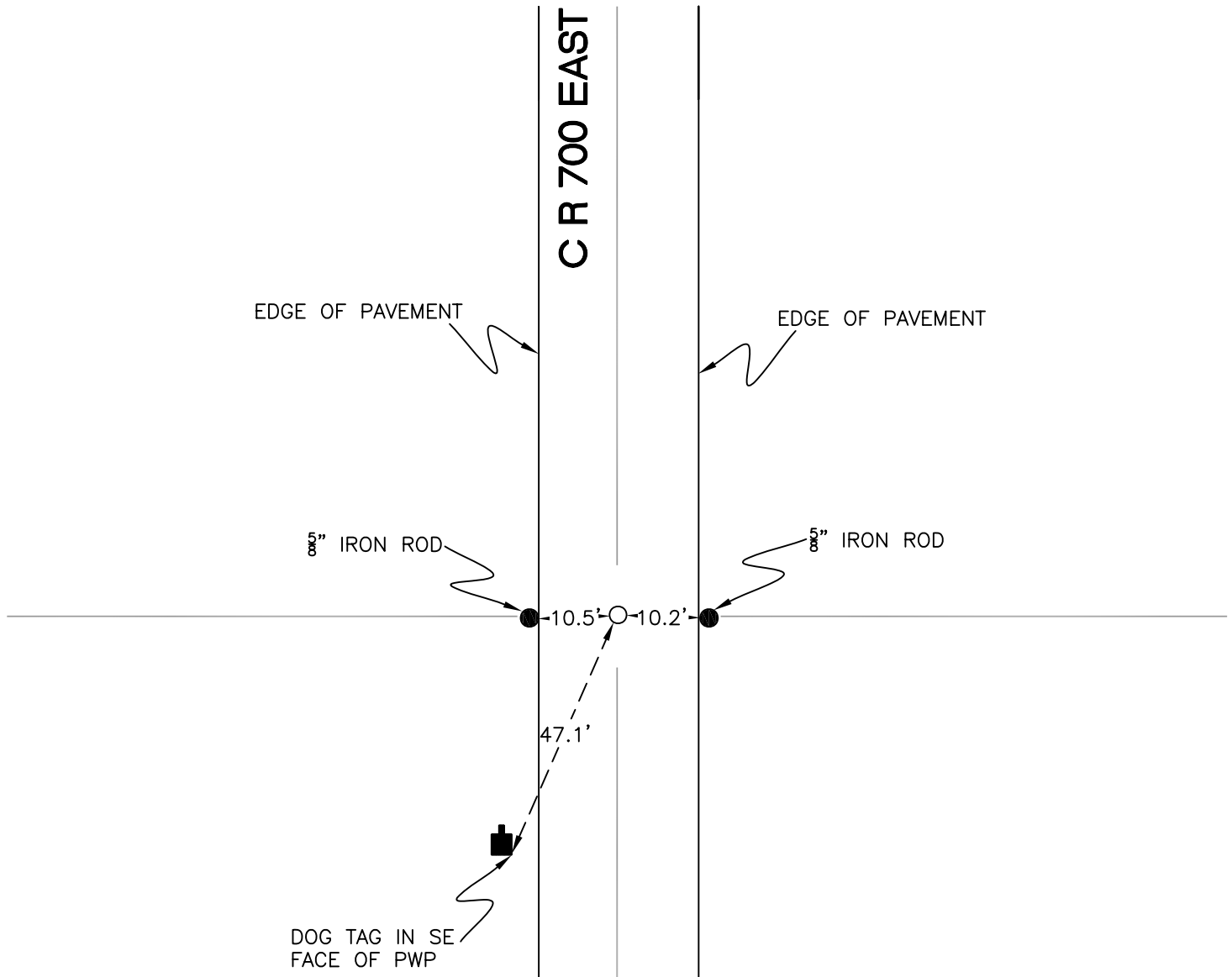

SECTION 30

SECTION 29

MONUMENT: 1 1/2" IRON PIPE

PARTY: JL

DATE: 8/22/12

COMMENTS: REFERENCED BY WIGHTMAN CRAMER IN 1996. USED BY GRAND KANKAKEE SURVEY IN 2007.

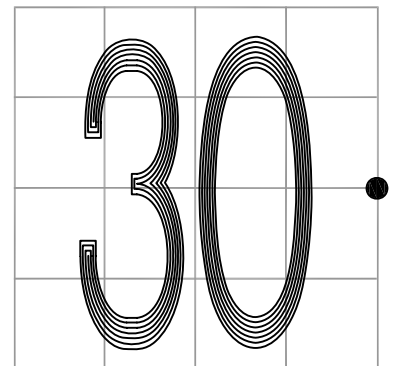

CORNER LOCATION IN THE SECTION

T5