

RAILROAD TOWNSHIP

T 32 N, R 4 W

T5

SECTION 30

SECTION 29

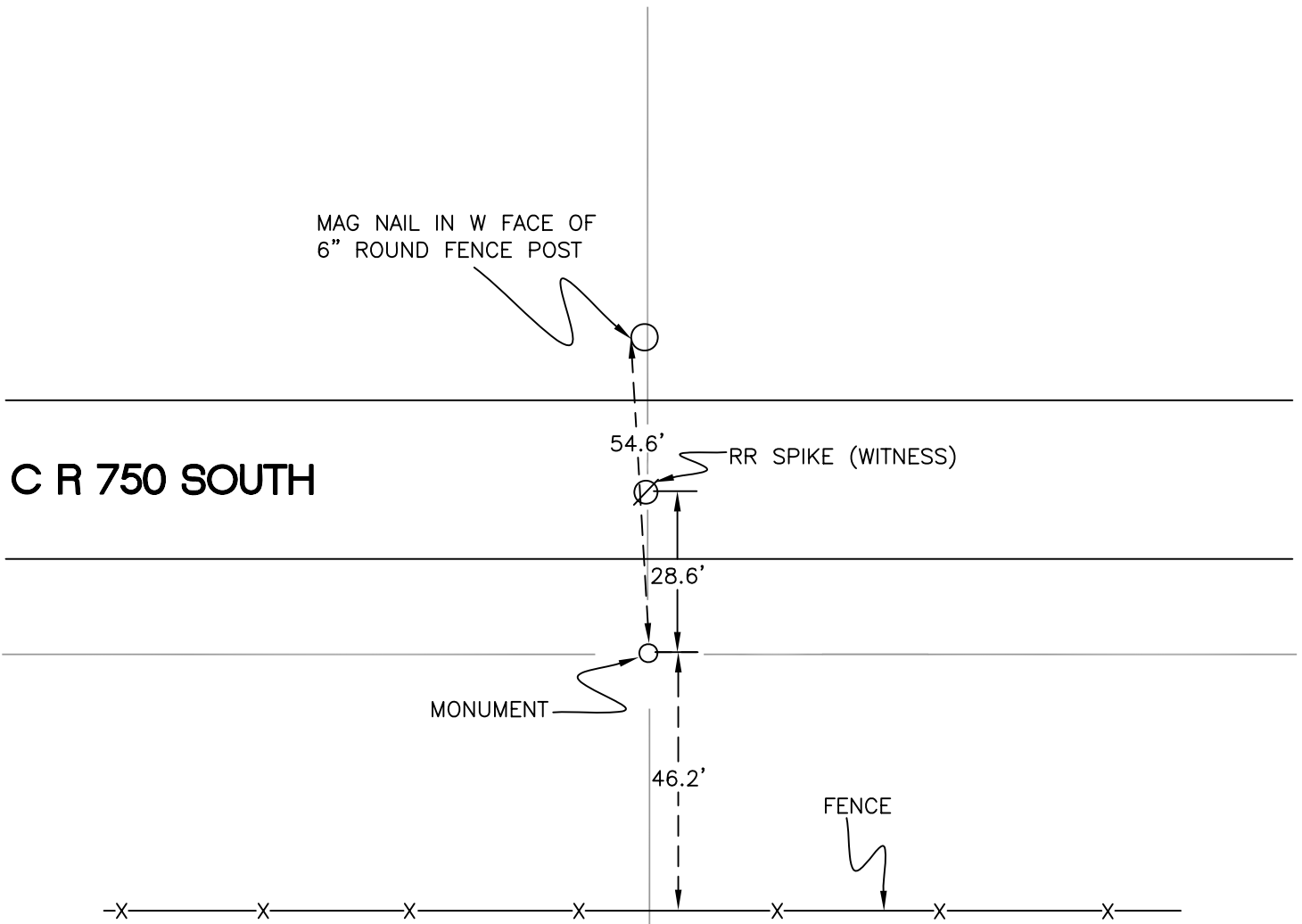

SECTION 30

SECTION 29

MONUMENT: 1" IRON PIPE w/ 910004 CAP

PARTY: DPS/REZ

DATE: 2015

COMMENTS: SET BY WIGHTMAN CRAMER IN 1995 MIDWAY
BETWEEN NW AND SW CORNERS OF SECTION 29.
MONUMENT IS 31.9' S OF \mathcal{C} OF 750 S.

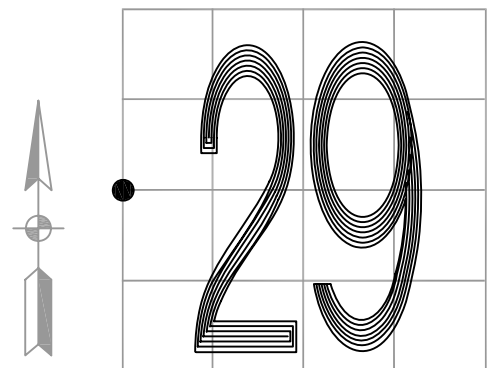

CORNER LOCATION IN THE SECTION

T5