

CALIFORNIA TOWNSHIP

T 32 N, R 2 W

V19

SECTION 26

SECTION 26

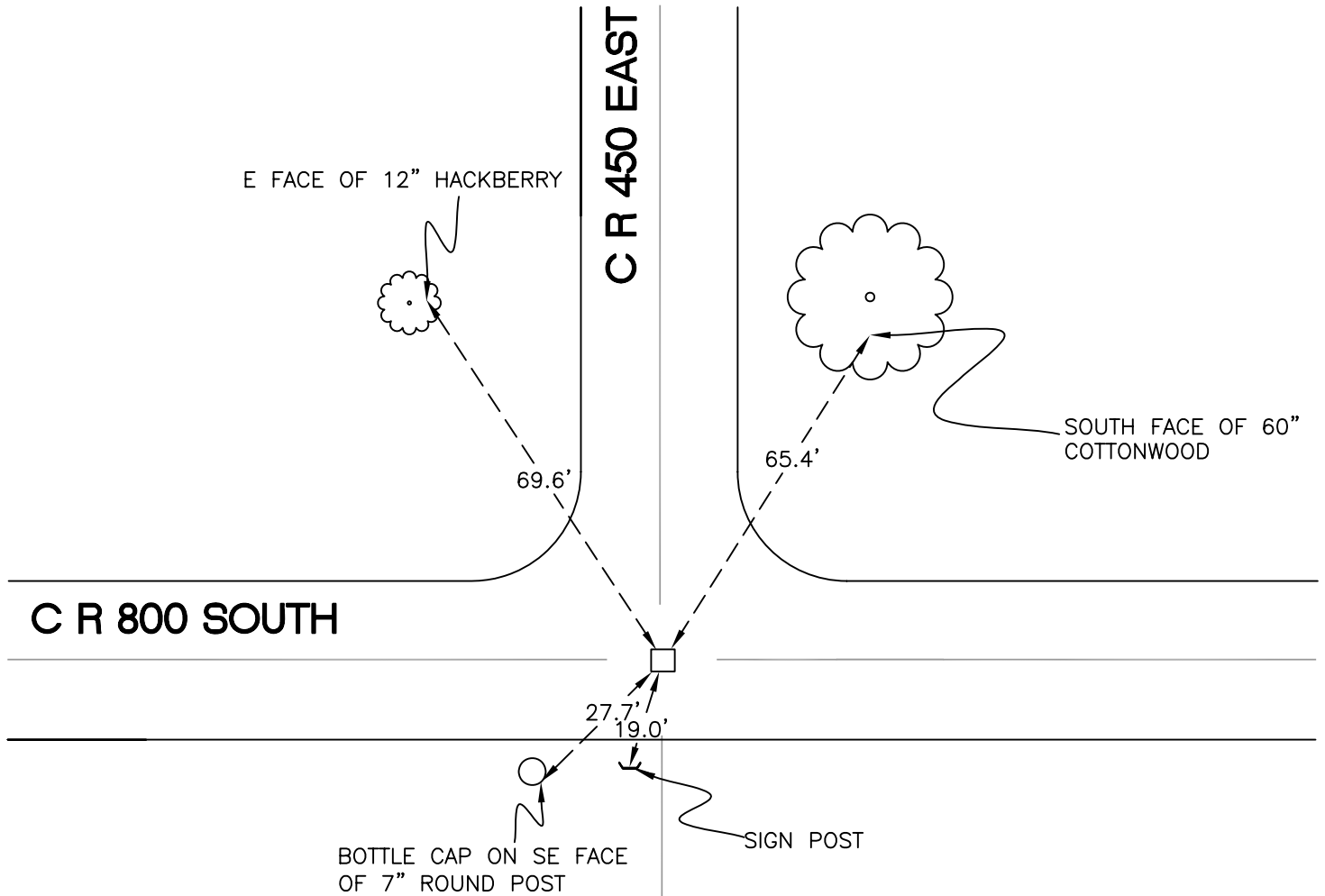

SECTION 35

SECTION 35

MONUMENT: BOAT SPIKE

PARTY: DPS/JL

DATE: 7/14/14

COMMENTS: MONUMENT IS 2" BELOW GRADE. CROSSING BOLT FOUND BY VHJ IN 1981. DISTANCES FROM THE BOAT SPIKE TO THE THREE REMAINING REFERENCES FROM 1981 AGREE WITH 1981 DIMENSIONS.

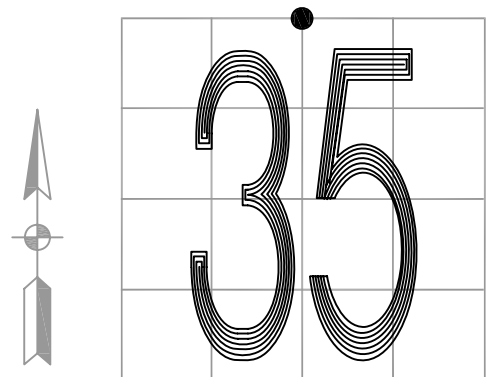

CORNER LOCATION IN THE SECTION

V19