

NORTH BEND TOWNSHIP

T 32 N, R 1 W

V3

SECTION 30

SECTION 30

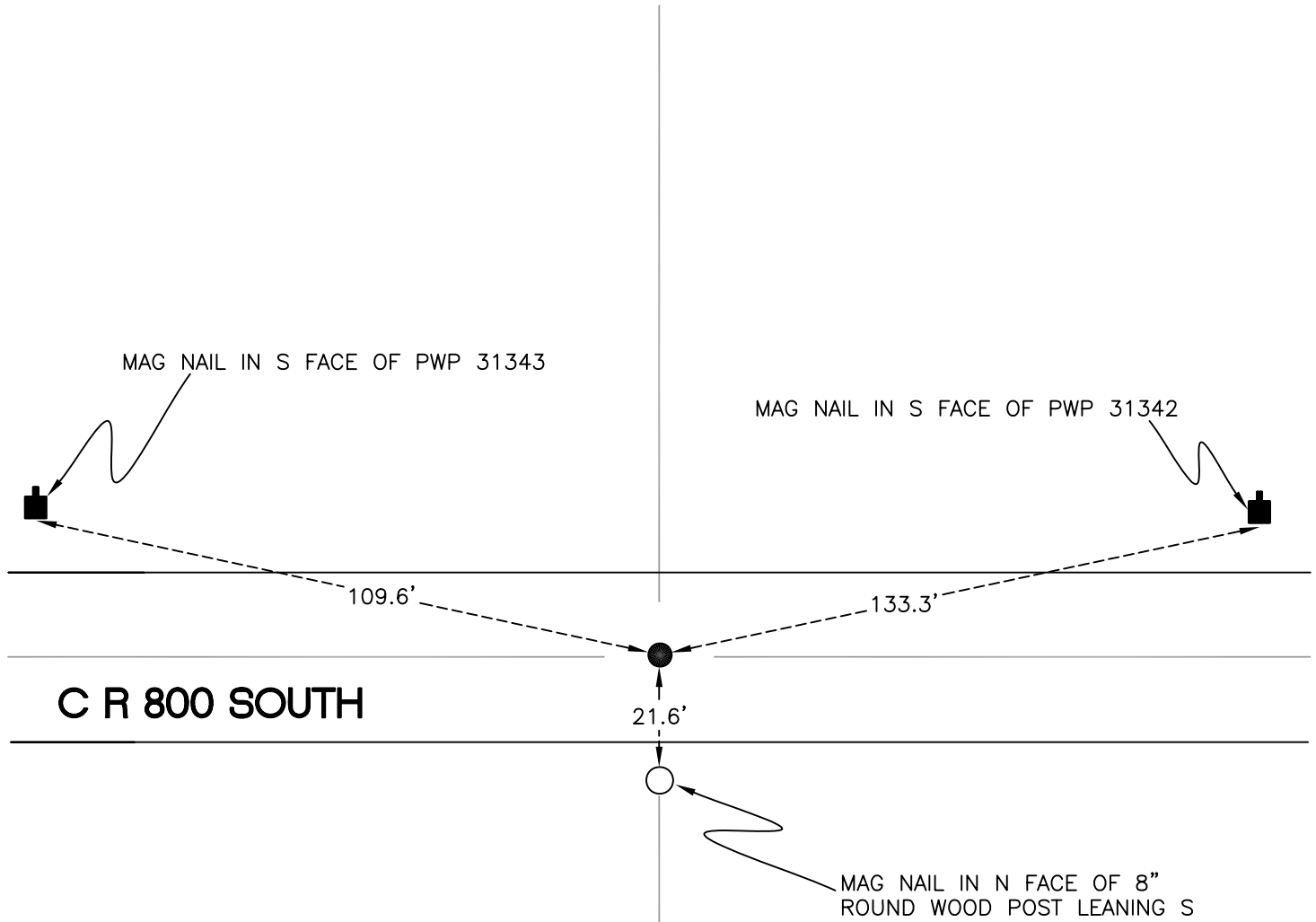

SECTION 31

SECTION 31

MONUMENT: 3/4" IRON ROD

PARTY: JL/AO

DATE: 6/7/12

COMMENTS: 2" BELOW GRADE
FOUND IN 1977 BY CETA AND 1984 BY RLP

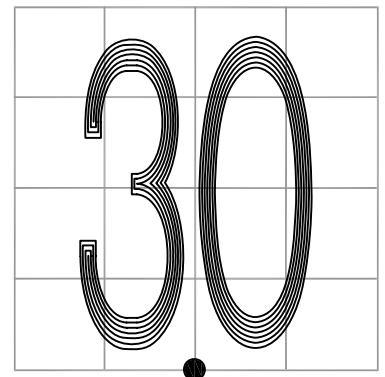

CORNER LOCATION IN THE SECTION

V3