

RAILROAD TOWNSHIP

T 32 N, R 4 W

X1

SECTION 36
KANKAKEE TOWNSHIP
JASPER COUNTY

SECTION 31
RAILROAD TOWNSHIP
STARKE COUNTY

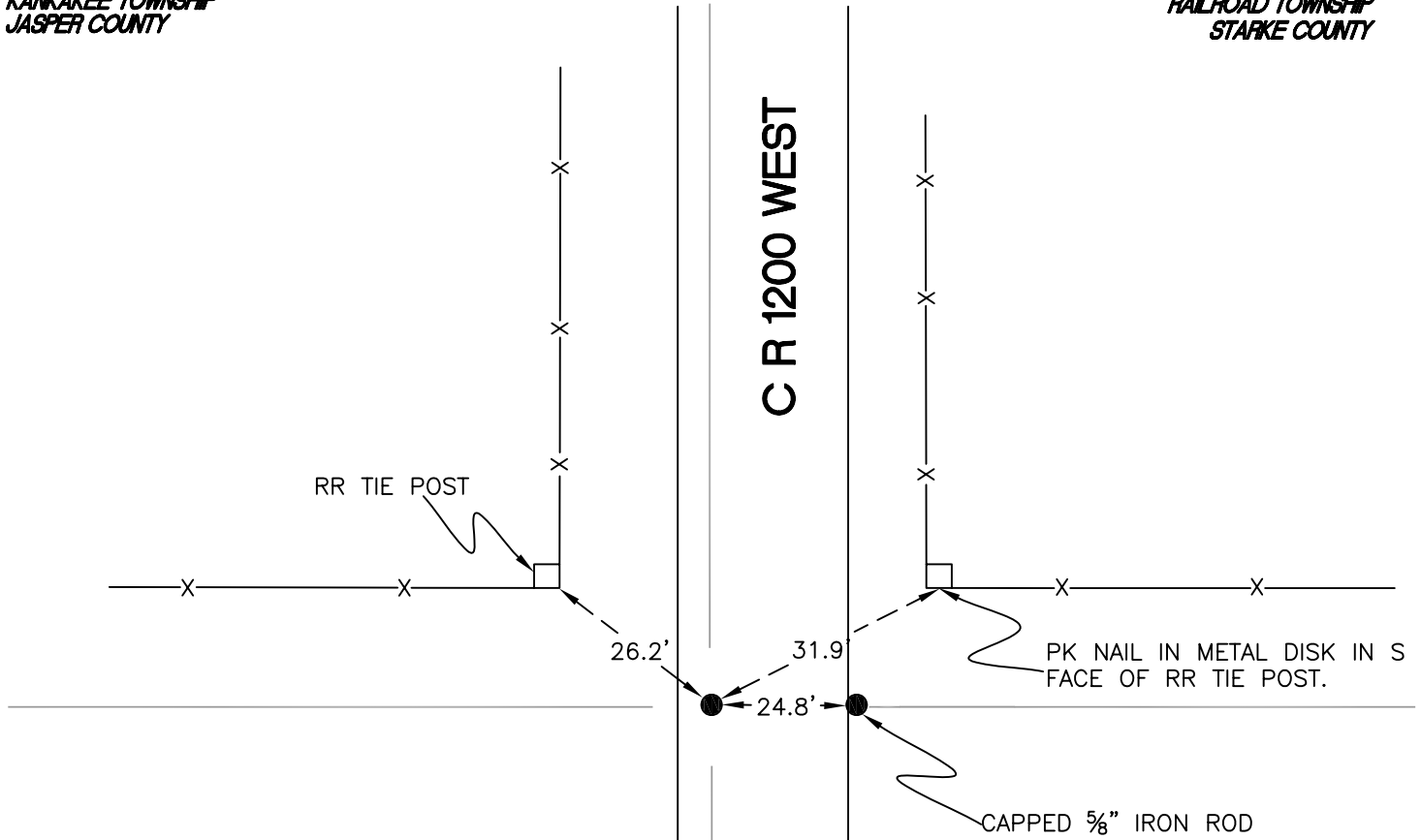

SECTION 36
KANKAKEE TOWNSHIP
JASPER COUNTY

SECTION 31
RAILROAD TOWNSHIP
STARKE COUNTY

MONUMENT: 1/2" IRON ROD

PARTY: DPS/JL

DATE: 5/8/2015

COMMENTS: MONUMENT IS 7' W OF \oslash OF 1200 W.
FOUND BY DWC/SJF IN 1990.

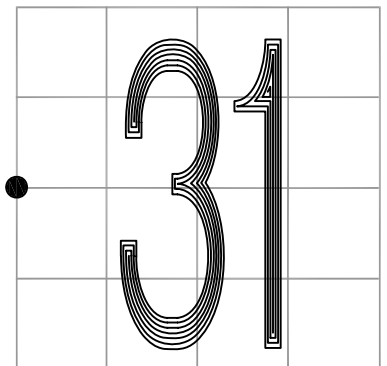

CORNER LOCATION IN THE SECTION

X1