

CASS TOWNSHIP

PULASKI COUNTY  
T31N R4W

Thomas L. Newport  
Ind. Surveyor No. 50123  
Rural Route 1 Box 111  
WALTON, INDIANA 46994

CORNER LOCATION

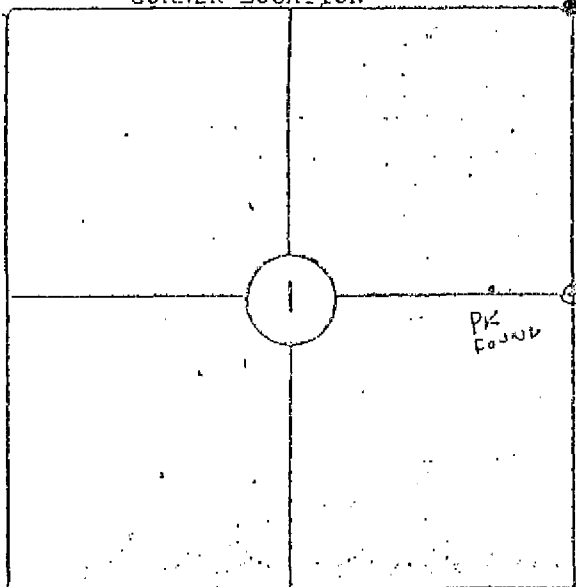

CORNER NO.	P-2
RECORD CORNER INFORMATION	POST
FOUND	NOTHING
DEPTH	
MARKINGS	
SET	RR SPIKE @ R/W SPLIT
REMARKS	DIG 2' TO WELL BELOW VIRGIN SOIL

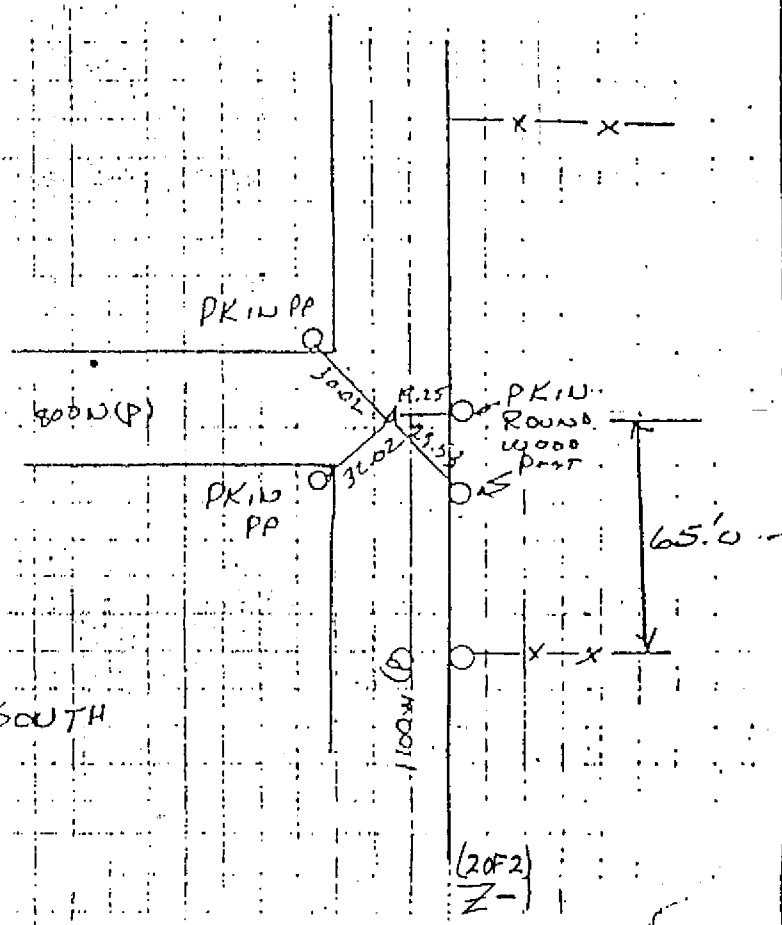

MADE 2 DIGGS  
1 @ R/W SPLIT  
1 @ FENCE TO SOUTH