

# CALIFORNIA TOWNSHIP

T 32 N, R 2 W

## Z25

SECTION 36  
CALIFORNIA TOWNSHIP  
STARKE COUNTY

SECTION 31  
NORTH BEND TOWNSHIP  
STARKE COUNTY

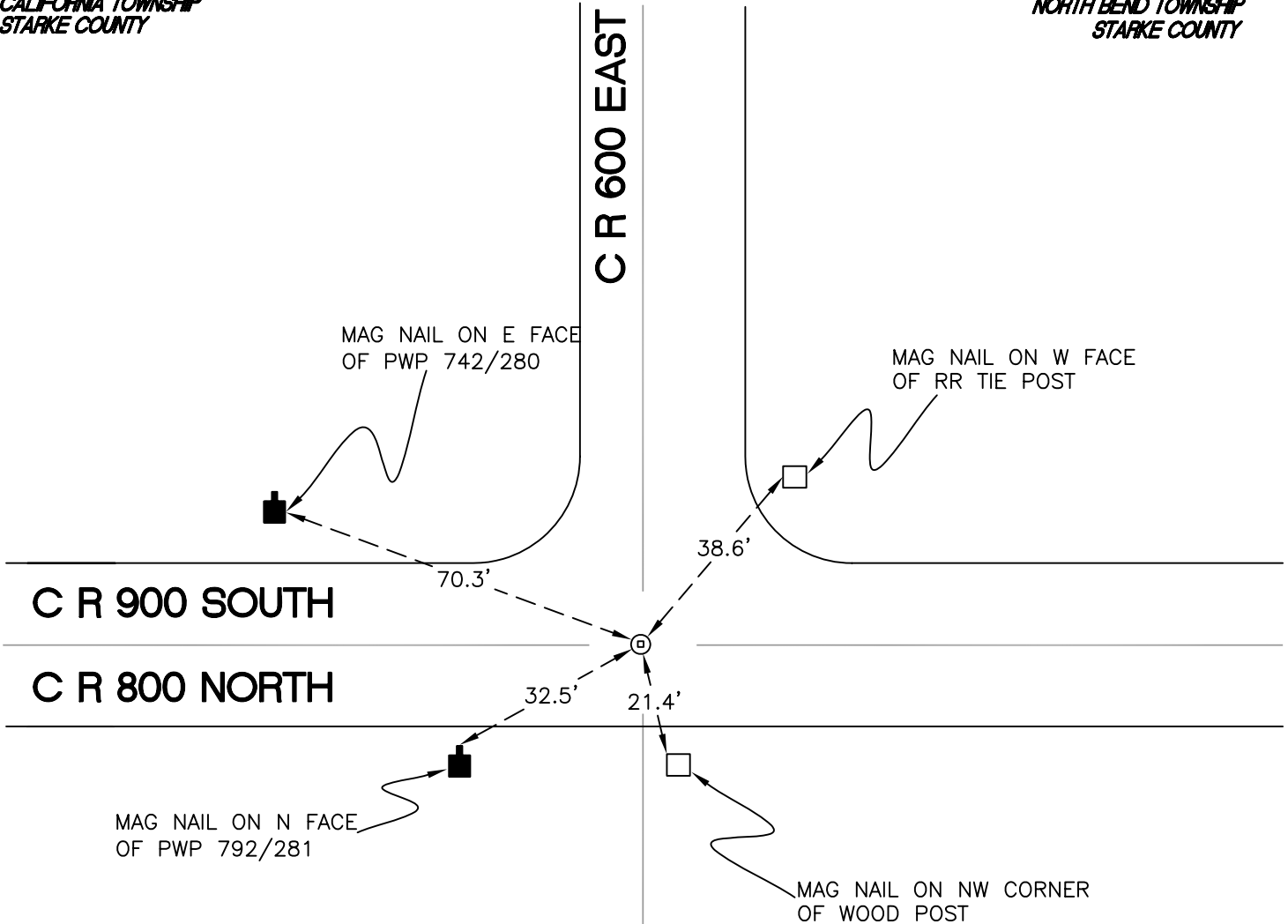

SECTION 1  
FRANKLIN TOWNSHIP  
PULASKI COUNTY

SECTION 6  
TIPPECANOE TOWNSHIP  
PULASKI COUNTY

MONUMENT: RR CROSSING BOLT ON TOP OF STONE

PARTY: DPS/JL

DATE: 7/15/14

COMMENTS: 3' W OF 600 E. REPLACED RR SPIKE WITH CROSSING BOLT IN 2012. STONE SET IN 1889; FOUND BY DLA IN 1992.

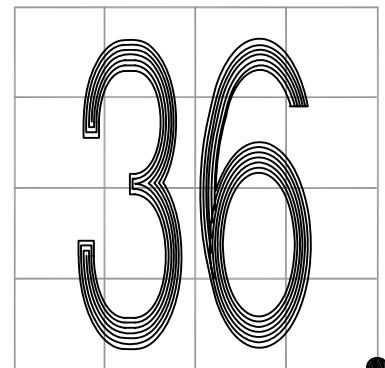

CORNER LOCATION IN THE SECTION

## Z25