

# WASHINGTON TOWNSHIP

## T 33 N, R 1 W

SECTION 31

SECTION 31

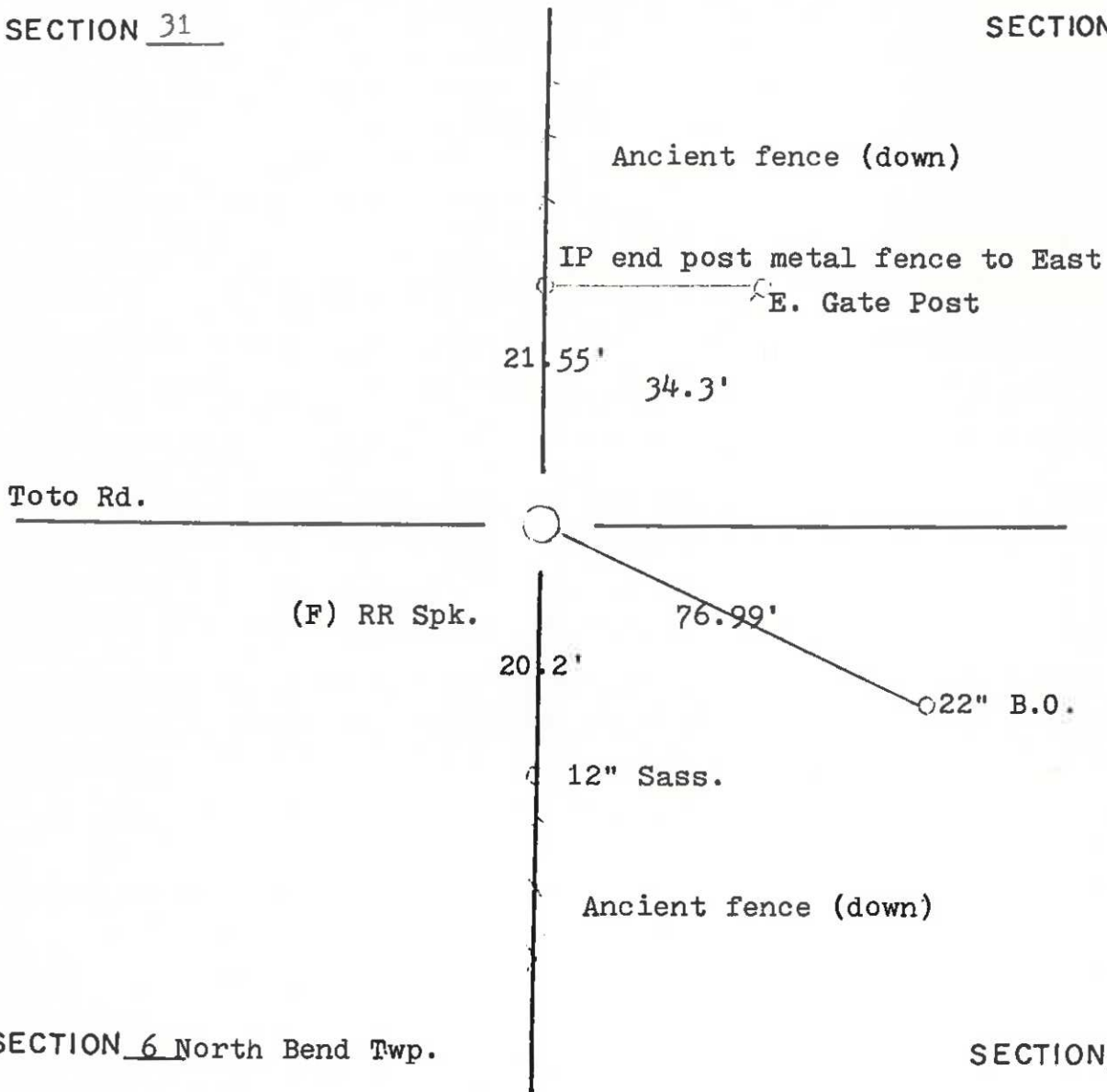

SECTION 6 North Bend Twp.

SECTION 6 N. Bend T.

DATE	BY	DATE	BY
31Oct1978	JBS		
27Mar1981	JBS/JGH		
11Jul1983	RLP		

CORNER OF: RECORD  USE

SOURCE OF INFORMATION:

Surveyor's Record "E", page 176  
 File  
 Field Book M-2, page 34