

STARKE COUNTY SECTION CORNER RECORD

MONUMENT: 1" IRON ROD (0.2'BG)

TOWNSHIP: OREGON

PARTY: DDC

DATE: 3/23/2021

COMMENTS:
NONE.

STATE PLANE COORDINATES

DATUM: NAD83

ZONE: INDIANA WEST 1302

NORTHING: 2221509.293

EASTING: 3098302.243

NOTE:
COORDINATES BASED ON INCORS NETWORK FOR GENERAL REFERENCE PURPOSES ONLY AND SHALL NOT BE USED FOR BOUNDARY SURVEY PURPOSES. STARKE COUNTY DOES NOT WARRANT OR GUARANTEE THE ACCURACY OF THIS DATA AND DISCLAIMS ANY RESPONSIBILITY OR LIABILITY FOR INTERPRETATIONS BASED ON USING THIS DATA FOR BOUNDARY DECISIONS.

LATITUDE: 41°20'45.57696"N

LONGITUDE: 86°33'11.64660"W

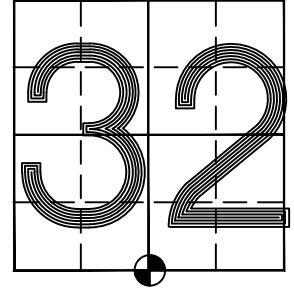

SEC.32-T34N-R1W

**SECTION 32
OREGON TWP.**

**SECTION 32
OREGON TWP.**



C.R. 300 NORTH

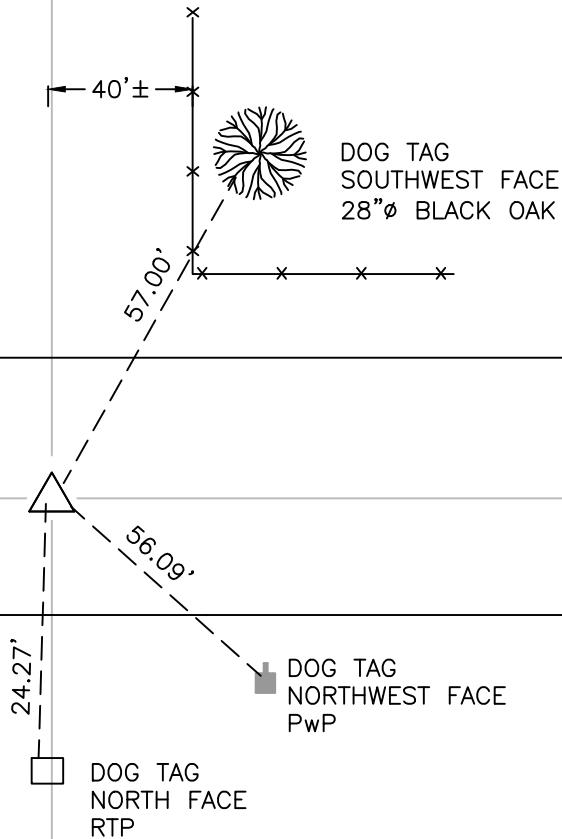

**SECTION 5
WASHINGTON TWP.**

**SECTION 5
WASHINGTON TWP.**